

KDF

Sports Flooring Systems & Building Materials

POLYFLEX PU EX OUTDOOR SPORT SYSTEM

www.kdf.gr

KDF LTD (www.kdf.gr) is one of the most dynamic and export-oriented Greek companies (currently activated in more than 70 countries in 4 continents), based in Greece (EU) and in U.A.E too, with production facilities and warehouses in both countries for acrylics and polyurethanes and **EPDM** granules.

We are experts in sports, industrial and decorative flooring products and systems, with huge experience in Europe with many applied projects in Spain, France, Greece as well as Malta, Romania, Bulgaria, Croatia, Serbia and Ukraine. Our presence is active in Latin America too with projects in Colombia, Peru, Chile, and Brazil, Africa, Asia, Middle East and India as well.

Our export horizon is expanding rapidly, and our goal is to stand out as a model of flexibility and competitiveness. The company, being one of the pioneer companies in the sector of sports flooring systems and building materials and giving particular attention to providing a fully upgraded range of products and services, provides certified systems according to all **EU norms and regulations** and by well-known international institutes like **WORLD ATHLETICS, I.T.F, TUV, LNE, LABOSPORT, ISASPORT, INTERTEK to name but a few.**

KDF goes far beyond trade, providing consultancy in marketing and technical support all the way, from the costing till the finalization of the project. Operating under the requirements of **ISO 9001/2015** (and many others like **ISO 14001/2015, ISO 50001/2018, ISO 27001/2013** and more) for production, trade and application, we make sure our products are first applied successfully at site by our own people before we launch them abroad.

Therefore, our systems have all stood the real-life test in different climates, from North Europe to Middle East till South America, and this is one of our main assets, enabling us to provide full and vertical technical support from specifying to final application plus supervision when required or even full application and costing.

We invite you to discover a world of sports flooring expertise and solutions.

VIEW OUR NEW SPORTS CATALOGUE



KDF - Kataskeves Dapedon LTD
e : exports@kdf.gr
w : www.kdf.gr

19th km National Road Thessaloniki-Moudania
57001, Neo Rysio, Thessaloniki, Greece
t / f : +30 2310 829598

Contents

- 3. Technical Description of the system
- 4. Methodology of the system
- 9. Colorchart
- 11. Photographs of Projects
- 12. Technical Data Sheet (TDS) per each material
- 23. Maintenance manual
- 26. Indicative Reference List of Projects

OUTDOOR SPORTS FLOORING

POLYFLEX PU-EX

Outdoor highly resilient sports flooring system ideal for multipurpose areas, tennis, basketball, volleyball, handball, football courts, as well as any other outdoor sports court. Combination of prefabricated shock-pad and polyurethane coatings in 6mm up to 16mm average total thickness.

Certified system by LABOSPORT Institute and KIWA Institute.

Steps:

1. PU FLEX 140 - Special, polyurethane, two component adhesive.

It is applied with a V-notch trowel, on dry waterproof, smooth, power-troweled surfaces of concrete, without rising humidity issues, or asphalt. Used for the application of **ISOPOL 854** shock-pads or other prefabricated shock-absorbent rolls made from recycled rubber or **EPDM** granules.

2. ISOPOL 854 - Shock-pad in rolls.

Elastic, prefabricated shock-pad made of recycled rubber granules providing shock-absorbency, in thickness of 4mm up to 14mm. Used as cushion substrate before the application of polyurethane or acrylic systems.

3. POLYSPORT STUCCO 1050 - Polyurethane, elastic, two-component pore filler.

Used for sealing porous of wet-pour or prefabricated shock-absorbent sub-floor of sports flooring systems. Applied by flat trowel.

4. POLYSPORT PU 1051 - Polyurethane, self-leveling, two-component coat for outdoor sports surfaces.

It is combined with **ISOPOL 854** as substrate to create multi-purpose shock-absorbent resilient sports flooring systems. Pore filling with **POLYSPORT STUCCO 1050** precedes its application. Applied by a V-notch trowel and the parallel use of spiked roller.

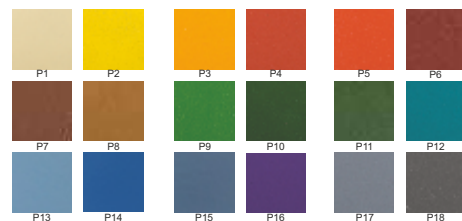
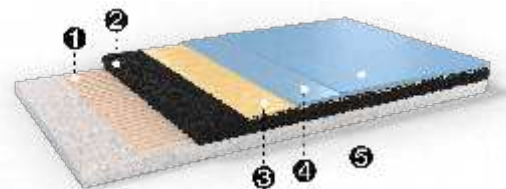

5. POLYSPORT 1052 - UV-resistant, polyurethane, aliphatic, two-component top coating for outdoor sports flooring.

Applied, in two crossing layers by airless sprayer or short haired mohair roller.

Description	Consumption
PU FLEX 140 - Special, polyurethane, two-component adhesive.	1kg/m ² for 1 layer
ISOPOL 854 - Shock-pad in rolls.	
POLYSPORT STUCCO 1050 - Polyurethane, elastic, two-component pore filler.	0.7-0.8kg/m ² for 2 layers on rolls
POLYSPORT PU 1051 - Polyurethane, self-leveling, two-component coat for outdoor sports surfaces.	2-2.2kg/m ² for 1 layer
POLYSPORT 1052 - UV-resistant, polyurethane, two-component, top coating for outdoor sports flooring.	0.25kg/m ² for 2 layers

SYSTEM POLYFLEX PU - EX
Total thickness of 6mm – 16mm

CERTIFIED BY LABOSPORT



Outdoor highly resilient sports flooring system ideal for multipurpose areas, tennis, basketball, volleyball, handball, football courts, as well as any other outdoor sports court.

Combination of prefabricated shock-pad and polyurethane coatings in 6mm up to 16mm average total thickness.

Certified system by LABOSPORT Institute and KIWA Institute.

Steps:

1. **PU FLEX 140 - Special, polyurethane, two component adhesive.** It is applied with a V-notch trowel, on dry waterproof, smooth, power-troweled surfaces of concrete, without rising humidity issues, or asphalt. Used for the application of ISOPOL 854 shock-pads or other prefabricated shock-absorbent rolls made from recycled rubber or EPDM granules.
2. **ISOPOL 854 - Shock-pad in rolls.** Elastic, prefabricated shock-pad made of recycled rubber granules providing shock-absorbency, in thickness of 4mm up to 14mm. Used as cushion substrate before the application of polyurethane or acrylic systems.
3. **POLYSPORT STUCCO 1050 - Polyurethane, elastic, two-component pore filler.** Used for sealing porous of wet-pour or prefabricated shock-absorbent sub-floor of sports flooring systems. Applied by flat trowel.
4. **POLYSPORT PU 1051 - Polyurethane, self-leveling, two-component coat for outdoor sports surfaces.** It is combined with ISOPOL 854 as substrate to create multi-purpose shock-absorbent resilient sports flooring systems. Pore filling with POLYSPORT STUCCO 1050 precedes its application. Applied by a V-notch trowel and the parallel use of spiked roller.
5. **POLYSPORT 1052 - UV-resistant, polyurethane, aliphatic, two-component top coating for outdoor sports flooring.** Applied, in two crossing layers by airless sprayer or short haired mohair roller.

Preparation – Application

Applied only on dry waterproof concrete surfaces (over 40 days old from date of placement) without rising humidity issues and free of materials that might prevent bonding e.g. dust, loose particles, grease etc. The success in the application depends on the right preparation of the underlay and use of the material.

- **Good, dry** cleaning of the surface from dust and residues with vacuum cleaner and squeegees.
- Application of polyurethane glue, **PU FLEX 140**, with V-notch trowel with 2mm teeth. Consumption: 1kg/m².
- Place the **ISOPOL 854** rolls on the floor in their final positions without gluing them. Lift each side of each roll and apply the PU glue by a V-notch trowel with 2mm teeth and then glue the rolls immediately without waiting. In case there are small bulges (humps, swollen parts) on the roll after its application, you'll have to tear it around the edge of the hump without removing it completely, raise that small part, put some PU glue underneath and glue the hump part again, making sure this time it's flat. Weights such as sand bags have to be used on the edges, corners and seams of the shock absorbent roll surface installation until the PU glue is cured. Then you let everything dry. Do not overlap the rolls but bring them as close together as possible to eliminate gaps. The usage of a light cylinder (10-15kg maximum) will help to compact the rolls on the floor. It is recommended that the joints (only) are covered flush with ELASTOTURF 851 or PU FLEX 140 with a flat trowel (or a brush) along their whole length, so that the surface is leveled out. Next day the joints are ground lightly with sandpaper or other grinding device to smooth out the joints with the rest of the surface and create the required roughness.
- Sealing of prefabricated surface porosity using elastic pore sealer **POLYSPORT STUCCO 1050**. Care should be taken that the porosity of prefabricated subfloor should be totally covered using **POLYSPORT STUCCO 1050** to avoid surface defects on the final surface of **POLYSPORT PU 1051**. Consumption on prefabricated shock-pads: 0,8 kg per square meter in two layers.
- The next day, depending ambient temperature, follows application of **POLYSPORT PU 1051**. Components A (resin) & B (hardener). The mixed material must be used within 20-30 minutes of mixing at 25°C. The polyurethane mixture is poured on the floor and spread using a V-notch trowel with 5.5mm teeth. Consumption: 2,2 kg per square meter for 1 layer.
- Following the application of **POLYSPORT PU 1051**, the self-leveling layer should be rolled using a special spiked roller in order to release any possibly entrapped air and avoid the formation of bubbles. Sanding of the surface should be done after drying.
- The next day, depending ambient temperature follows application of finishing paint **POLYSPORT 1052** in 2 crossing layers by a short-haired mohair roller or even better by airless spray. Consumption: 0,25 kg per square meter in 2 layers.

Important Remarks

- During temperatures over 40 degrees, ideal time for the application of **POLYFLEX PU-EX SYSTEM** is between 22:00 and 09:00 and the minimum bearing temperature during application and drying should be over 10°C.
- In case the second layer of PU pore filler is applied after more than 24 hours of the application of the first one then the whole surface must be sanded by a special sanding machine. After that the second layer can be applied.
- In case the layer of PU self-leveling is applied after more than 24 hours of the application of the last layer of PU pore filler then the whole surface must be sanded by a special sanding machine. After that the PU self-leveling can be applied.

- In case the second layer of PU topcoat is applied after more than 24 hours of the application of the first one then the whole surface must be sanded by a special sanding machine. After that the second layer can be applied.
- The freshly coated surface should be protected from high temperatures, wind, rain and frost for at least the first 24 hours.
- In case it gets damaged, it is simply repaired and recoated on the spot.

Substrate

Asphalt is the safer subfloor for sport floorings for sure and must be always preferred than concrete surfaces.

A. Asphalt Substrate

The asphalt must have a slope of 0.7-1% and must dry for at least 30 days so that all solvents from the asphalt can evaporate.

The asphalt sub-floor should be applied on well compacted 150mm road base sub-floor and asphalt should be laid in one layer (and not 2) in 6 to 8cm with fine and coarse aggregates (up to 15mm granulometry) like the kind of asphalt used in road construction.

So, new road-grade asphalt will have to be laid (minimum 60mm) in one layer containing coarse aggregates and then mature for 30 days at least, before any application takes place on top of the asphalt to avoid bubbles on the final layer of the sport or rubber floorings.

Asphalt Infrastructure

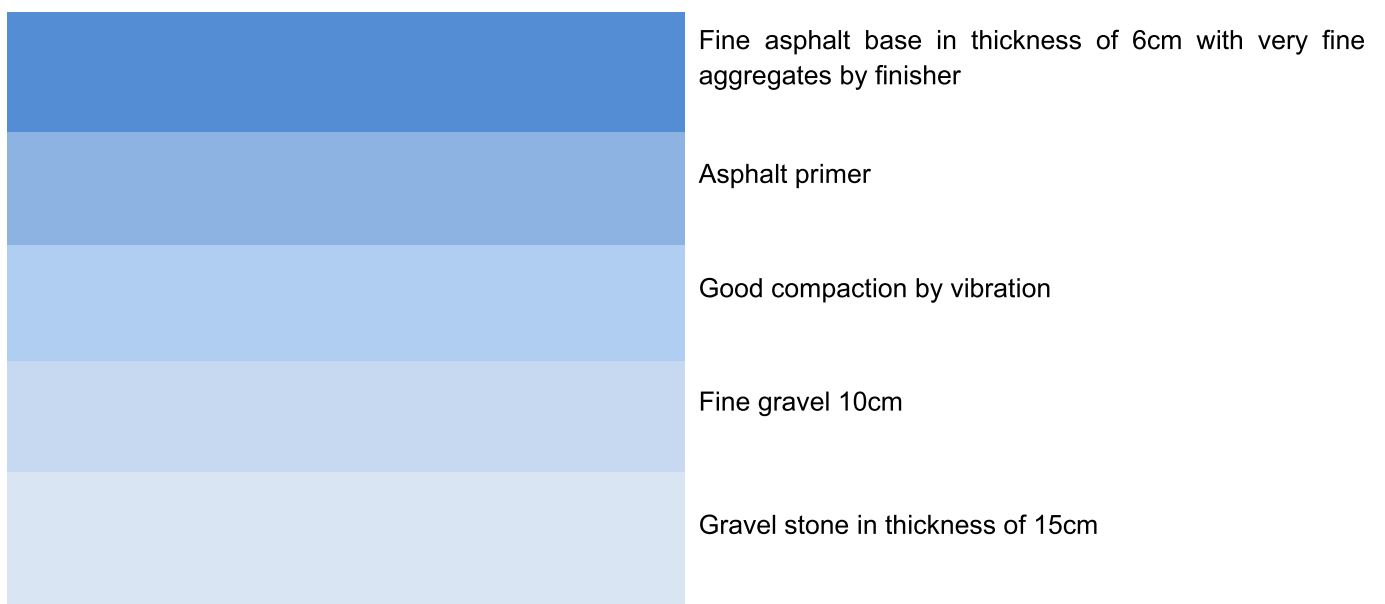

B. Concrete Surface

Concrete surface must be power-trowelled without cracks and must be smooth with a slope of 0.7-1% and humidity under 4% in 10cm depth of concrete.

Concrete must also be **dry at least for 40 days** and then the application takes place if there is no rising humidity for the sub-floor. Before the application takes place, there must be proper grinding of the surface by a grinding machine to open the pores accordingly and also a measurement by special instrument to measure humidity on the surface and in 10cm under the surface.

Generally concrete is a risky sub-floor and there may be problems with rising humidity, especially in areas where the sea level is really high and when the sea is close or in areas near greenery.

Always make expansion joints in large areas of concrete, in order to avoid uncontrollable cracks and failures. Joints should be every 25 square meters creating a grid of 5x5 meters or close to that.

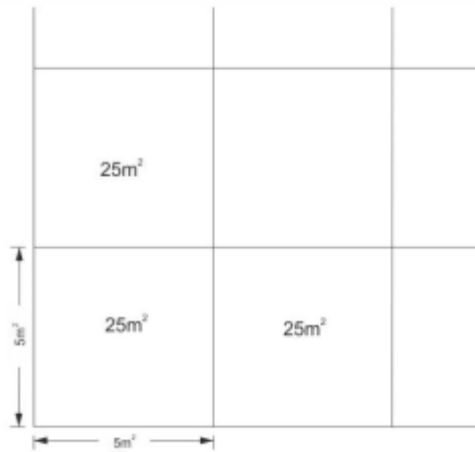

Substrate requirements:

Concrete quality	at least C20/25
Age:	at least 40 days
Moisture content:	below 4%

Tools:



V-notch trowel



airless sprayer



flat
trowel



heated roller



sandpaper machine



V-notch trowel



spiked roller



roller

PU COLORCHART



The colors may vary slightly from the original due to digital representation.

PU COLORCHART



The colors may vary slightly from the original due to digital representation.

PHOTOGRAPHS OF PROJECTS



PU FLEX 140

SPECIAL PU GLUE FOR THE APPLICATION OF PREFABRICATED SHOCK ABSORBENT ROLLS

GENERAL CHARACTERISTICS

PU FLEX 140 is a two component, adhesive for the application of prefabricated shock-absorbent rolls made of recycled rubber or from EPDM granules and also for safety tiles.

- It is applied on dry, sealed surfaces of mosaic, concrete or asphalt.
- Suitable for interior and exterior use.
- Provides good filling properties.
- Non shrinking.

TECHNICAL DATA

Mixing ratio:	87.5% : 12.5% (By weight)
Density (25°C):	1.67-1.77 kg/lt
Viscosity	9.000-18.000 mPas
Pot-life (25°C):	20-30 min.
Application temperature:	Min 10°C
Curing (25°C and %60 relative humidity):	6 - 9 hours
Color and odor:	Beige

PREPARATION-APPLICATION

Applied only on dry, level surfaces. Protected from arising humidity and free of materials that might prevent bonding e.g. dust, loose particles, grease etc. The success in the application depends on the right preparation of the underlay and use of the material.

- **Good, dry** cleaning of the surface from dust and residues using brushes and air spray.
- Good mixing of components A (resin) & B (hardener) packed into separate containers in fixed weight proportions. Mixing should be performed using a 300-600 rpm mixer for 2-3 min until a uniform mass is obtained. Stirring of the mixture should be performed thoroughly near the sides and bottom of the container in order to achieve uniform dispersion of the hardener.
- The mixed adhesive **PU FLEX 140** is applied under each roll using a V notched trowel (3mm), as soon as possible in order to avoid any problems with the limited pot life. A roller should be used on the top of the shock absorbent rolls within an hour after the adhesive has been mixed.
- Light foot traffic is permitted after 6 hours(25°C). Full curing needs 2 days.

CONSUMPTION

1 – 1.5 kg/m² depending on the sub-floor and type of floor covering.

APPLICATION TOOLS

V - Notched trowels (3mm). Tools should be cleaned with **PU SOLVENT** immediately after use.



PACKAGING

Supplied in set of 24 Kg.



STORAGE

One year in unopened containers in dry places with minimum temperature 5°C and maximum temperature 30°C (avoid sunlight).

REMARKS

- Working time of **PU FLEX 140** decreases when ambient temperature rises.
- Avoid application of **PU FLEX 140** during rain, moist or foggy weather.
- Prolonged storage of partially used containers containing **PU FLEX 140** must be avoided as contact with atmospheric moisture will result in skinning and clouding of the product.
- When laying flooring over an underfloor heating system, caution must be taken so that the heating system is left in full operation for at least 8-10 days before the application. The screed must be dry prior application. Before laying, however, the heating system must be switched off or reduced, so that a surface temperature of 20-22 °C is not exceeded.

CAUTION

The application must take place in well-aired places using protective gloves. Skin or eye contact must be avoided, otherwise wash carefully with soap and water.

For more information consult the safety data sheet.

The information given here is true, represents our best knowledge and is based not only on laboratory work, but also on field experience. However, because of numerous factors affecting results we offer this information without any guarantee and no patent liability is assumed. For additional information or questions, contact the technical department of KDF LTD.

ISOPOL 854

SHOCK ABSORBENT UNDERFLOOR

GENERAL CHARACTERISTICS

Elastic, prefabricated roll made of polymerically bound recycled rubber particles for shock-absorbency, in thickness of 3mm up to 14mm. It is covered with the acrylic coating **ELASTOTURF 851** or self-leveling PU coating, in thickness of 2mm, for the creation of athletic floorings for interior & exterior surfaces like basketball, volleyball, handball, football and tennis courts as well as for playgrounds. The point elastic sport surface possess good elasticity and force reduction characteristics as well as fulfilling a protective function for the athletes' joints and muscles. Its special cushion properties are indeed recommended for multipurpose.

Suitable for external & internal courts with acrylic top coatings, internal halls with PU top coating, gyms, cross-fit areas and generally areas which need elastic flooring. Ideal also as sub-floor for athletic tracks.

- ✓ Offers noise abatement
- ✓ Slip resistant
- ✓ Fire resistant
- ✓ Environmentally friendly
- ✓ Flexible
- ✓ Resistant against moisture, heat and mildew
- ✓ Easy application

PREPARATION-APPLICATION

The sub-surface on which the material will be installed must be completely dry and clear of all foreign matter and free of dust, dirt, oil or any kind of spills.

The material surface will follow the contours of the sub-surface, which it covers. The smoother the sub-surface, the better the shock-absorbent material surfacing finishes.

Place the **ISOPOL 854** rolls on the floor in their final positions without gluing them. Lift each side of each roll and apply the PU glue by a V-notch trowel with 3mm notches and then glue the rolls immediately without waiting.

In case there are small bulges (humps, swollen parts) on the roll after its application, you'll have to tear it around the edge of the hump without removing it completely, raise that small part, put some PU glue underneath and glue the hump part again, making sure this time it's flat. Weights such as sand bags have to be used on the edges, corners and seams of the shock absorbent roll surface installation until the PU glue is cured. Then you let everything dry.

Do not overlap the rolls but bring them as close together as possible to eliminate gaps. The usage of a light cylinder (10-15kg maximum) will help to compact the rolls on the floor.

It is recommended that the joints (only) are covered flush with **ELASTOTURF 851** or **PU FLEX 140** with a flat trowel (or a brush) along their whole length, so that the surface is leveled out. Next day the joints are ground lightly with sandpaper or other grinding device to smooth out the joints with the rest of the surface and create the required roughness.

COLOR

Black.

SURFACE

Fine tuned granules structure.

DIMENSIONS

Rolls Width : 1050mm, 1250mm or 2100mm \pm 1.5%

Rolls Length according to demand.

THICKNESS

4- 14mm \pm 0.3mm

DENSITY

730 kg/m³ \pm 5%

TECHNICAL DATA

Tensile strength: approx.0,56 MPa at 7mm: approx. 0,65 MPa at 10mm (DIN EN ISO 1978)

Elongation at break: approx.57% at 7mm: approx. 60% at 10mm (DIN EN ISO 1978)

Force reduction*: 8 mm Isopol 25 %

10 mm Isopol 30 %

(Value for mats only, not on complete floor)

Vertical deformation*: 1,2 mm at 8 mm Isopol

*Values measured on a sport hall system sample.

The information given here is true, represents our best knowledge and is based not only on laboratory work, but also on field experience. However, because of numerous factors affecting results we offer this information without any guarantee and no patent liability is assumed. For additional information or questions, contact the technical department of KDF LTD.

POLYSPORT STUCCO 1050

POLYURETHANE, ELASTIC, TWO-COMPONENT PORE FILLER

GENERAL CHARACTERISTICS

POLYSPORT STUCCO 1050 is elastic solvent-free, two component polyurethane based sealant for outdoor sport surfaces.

POLYSPORT STUCCO 1050 has very good filling capacity and thixotropic properties. It has low fluidity feature with its filler structure can be easily applied. It provides strong and elastic filling after the reaction.

TECHNICAL DATA

Mixing Ratio	88.64 : 11.36 (By weight)
Density of mixture (25°C)	1.50-1.60 Kg/lt
Viscosity of mixture (25°C)	70.000-90.000 mPa•s at 25°C
Pot-life (25°C)	20-30 min at 25°C
Application temperature	Min 10 – 40 °C
Curing (25°C and %60 relative humidity)	After 24 hours
Color	Beige

PREPARATION-APPLICATION

Applied on dry surfaces without rising humidity issues, free of materials that might prevent bonding e.g. dust, loose particles, grease etc (in case of asphalt or concrete). The success in the application depends on the right preparation of the underlay and use of the material.

- **Good, dry** cleaning of the surface from dust and residues using vacuum cleaner and squeegees.
- It can be applied directly on top of surfaces, on a cast-in-situ cushion base layer of wet pour (SBR rubber granules mixed with polyurethane binder) or prefabricated roll, which have to be dry, load bearing, clean and free of loose and brittle particles and substances which impair adhesion such as oil, grease, paint or other contaminants.
- The A component should be thoroughly stirred to incorporate any slight separation, while continuing stirring the contents of the B component (hardener) should be added. Continue stirring until a homogeneous mix is obtained. The mixed material must be used within 20-30 minutes of mixing at 25°C The surface must be dry and clean from dust and residues. Application is done by flat metal trowel.

CONSUMPTION

0.8 - 2.5 kg/m², depending on the porosity of the subfloor.

APPLICATION TOOLS

Flat metal trowel.



PACKAGING

Set of 250 kg (barrels and drums).



STORAGE

One year in unopened containers in cool and dry places, out of sunlight, with minimum temperature 5°C and maximum temperature 30°C.

REMARKS

- Substrate must be dry, clean, and free from dust, grease and oil. Application must be done between 10°C - 40°C.
- In case the second layer of PU pore filler is applied after more than 24 hours of the application of the first one then the whole surface must be sanded by a special sanding machine. After that the second layer can be applied.

CAUTION

Harmful if swallowed. Seek immediately medical attention. Rubber gloves and safety glasses with side guards should be worn.

For more information consult the safety data sheet.

The information given here is true, represents our best knowledge and is based not only on laboratory work, but also on field experience. However, because of numerous factors affecting results we offer this information without any guarantee and no patent liability is assumed. For additional information or questions, contact the technical department of KDF LTD.

POLYSPORT PU 1051

POLYURETHANE, SELF-LEVELING, TWO-COMPONENT COATING

GENERAL CHARACTERISTICS

POLYSPORT PU 1051 is a solvent-free, polyurethane-based, two-component, self-leveling coating for outdoor sport surfaces.

POLYSPORT PU 1051 has excellent mechanical properties; like high impact.

It is applied on prefabricated subfloors of sports flooring such as **ISOPOL 854**, shock-pad in rolls, or wet-pour rubber cushion mix of SBR rubber granules and **PU BINDER 1118** after they are sealed with elastic pore sealer **POLYSPORT STUCCO 1050**. Combines finally polyurethane finish paint **POLYSPORT 1052** for the creation of a multilayer polyurethane floor especially designed for sport halls such as tennis, basketball, handball, volleyball and multipurpose halls.

- Applies easily with trowel, providing excellent self-leveling properties.
- Highly flexible and elastic contributing in the athletic performance of the flooring.
- Non shrinking.

TECHNICAL DATA

Mixing Ratio (By weight)	86.96 : 13.04 By weight
Density (25°C) mixture	1.40 – 1.50 Kg/Lt
Viscosity(25°C)	3.500 – 8.000 mPa•s at 25°C
Pot-life (25°C)	20 - 30 min at 25° C
Hardness (Shore A)	80
Application temperature	10 – 40 °C
Curing (25°C and %60 relative humidity)	After 24 hours
Color	KDF's Color chart

PREPARATION-APPLICATION

Applied on dry surfaces without rising humidity issues, free of materials that might prevent bonding e.g. dust, loose particles, grease etc (in case of asphalt or concrete). The success in the application depends on the right preparation of the underlay and use of the material.

- **Good, dry** cleaning of the surface from dust and residues using vacuum cleaner and squeegees.
- Caution must be taken so that temperature of the support surface as well as ambient air remains above 10° C during application and curing of the materials while relative humidity does not exceed 75%.
- Depending on the ambient temperature, follows application of **POLYSPORT PU 1051**. Components A & B (hardener) packed into separate containers in fixed weight proportions are mixed together using a low revolution mixer (300-600 rpm) for 1-2 min. Stirring of the mixture should be performed thoroughly near the sides and bottom of the container in order to achieve uniform dispersion of the hardener. The resin component should be thoroughly stirred to incorporate any slight separation, whilst continuing stirring the contents of the hardener container should be added. Continue stirring until a homogeneous mix is obtained. The mixed material must be used within 20-30 minutes of mixing at 25°C.
- The polyurethane mixture is poured on the floor and spread using V - notched trowel 5.5 mm, with parallel use of special spiked-roller in order to release any possibly entrapped air and avoid the formation of bubbles.
- The next day, depending ambient temperature follows application of finishing paint **POLYSPORT 1052** in two layers.

CONSUMPTION

2.0 - 2.2 Kg/m² for 1 layer

APPLICATION TOOLS

V - Notched trowel 5.5 mm, spiked-roller. Tools should be cleaned with **PU SOLVENT** immediately after use.



PACKAGING

Set of 280 kg (barrel and drum).



STORAGE

12 months in unopened containers in dry places with minimum temperature 5°C and maximum temperature 30°C (avoid sunlight).

REMARKS

- Substrate must be dry, clean, free from dust, grease and oil. Application must be done between 10°C and 40°C.
 - In case the layer of PU self-leveling is applied after more than 24 hours of the application of the last layer of PU pore filler then the whole surface must be sanded by a special sanding machine. After that the PU self-leveling can be applied.
-

CAUTION

The application must take place in well-aired places using protective gloves. Skin or eye contact must be avoided, otherwise wash carefully with soap and water.

For more information consult the safety data sheet.

The information given here is true, represents our best knowledge and is based not only on laboratory work, but also on field experience. However, because of numerous factors affecting results we offer this information without any guarantee and no patent liability is assumed. For additional information or questions, contact the technical department of KDF LTD.

POLYSPORT 1052-SEMIMAT

UV-RESISTANT, POLYURETHANE-BASED, TWO-COMPONENT, SEMIMAT, FINISH ALIPHATIC COATING

GENERAL CHARACTERISTICS

POLYSPORT 1052-SEMIMAT is a polyurethane, two-component, solvent-based, with semi-mat finish aliphatic coating for outdoor sports surfaces.

- It is applied as a final, sealing layer on top of playground floorings made of **SBR rubber granules** plus **PU binder** mixture, or **EPDM** plus **PU binder** mixture, on safety tiles and on top of polyurethane outdoor sports systems such as **POLYFLEX PU-EX**.
- It is UV-resistant and thus absolutely suitable for outdoor surfaces, including running tracks, for UV-protection in case of sensitive, light colors such as blue, orange, green.
- Ideal for protection of EPDM rubber flooring.

TECHNICAL DATA

Mixing Ratio (colored)	85 :15 (By weight)
Density (25°C)	1.30-1.40 kg/lit
Viscosity (25°C)	800-2.500 mPas
Application Temperature	15 – 40 °C
Curing (25°C)	9-12 hours
Color	KDF colorchart

PREPARATION-APPLICATION

Applied on dry surfaces without rising humidity issues, free of materials that might prevent bonding e.g. dust, loose particles, grease etc (in case of asphalt or concrete). The success in the application depends on the right preparation of the underlay and use of the material.

- Good, dry cleaning of the surface from dust and residues using vacuum cleaner and squeegees.
- Caution must be taken so that temperature of the support surface as well as ambient air remains above 15° C during application and curing of the materials while relative humidity does not exceed 75%.
- The A component should be thoroughly stirred to incorporate any slight separation, while continuing stirring, the hardener (B component) should be added. Continue stirring until a homogeneous mix is obtained.
- The application is done by airless sprayer or short-haired mohair roller in 2 crossing layers.

CONSUMPTION

200-250 gr/m² on polyurethane floorings

400-500 gr/m² on running tracks or EPDM surfaces.

Apply two layers at least.

APPLICATION TOOLS

Short-haired mohair roller or airless sprayer. Tools should be cleaned with **PU SOLVENT** immediately after use.

POLYSPORT 1052-SEMIMAT

UV-RESISTANT, POLYURETHANE-BASED, TWO-COMPONENT, SEMIMAT, FINISH ALIPHATIC COATING

GENERAL CHARACTERISTICS

POLYSPORT 1052-SEMIMAT is a polyurethane, two-component, solvent-based, with semi-mat finish aliphatic coating for outdoor sports surfaces.

- It is applied as a final, sealing layer on top of playground floorings made of **SBR rubber granules** plus **PU binder** mixture, or **EPDM** plus **PU binder** mixture, on safety tiles and on top of polyurethane outdoor sports systems such as **POLYFLEX PU-EX**.
- It is UV-resistant and thus absolutely suitable for outdoor surfaces, including running tracks, for UV-protection in case of sensitive, light colors such as blue, orange, green.
- Ideal for protection of EPDM rubber flooring.

TECHNICAL DATA

Mixing Ratio (colored)	85 :15 (By weight)
Density (25°C)	1.30-1.40 kg/lit
Viscosity (25°C)	800-2.500 mPas
Application Temperature	15 – 40 °C
Curing (25°C)	9-12 hours
Color	KDF colorchart

PREPARATION-APPLICATION

Applied on dry surfaces without rising humidity issues, free of materials that might prevent bonding e.g. dust, loose particles, grease etc (in case of asphalt or concrete). The success in the application depends on the right preparation of the underlay and use of the material.

- Good, dry cleaning of the surface from dust and residues using vacuum cleaner and squeegees.
- Caution must be taken so that temperature of the support surface as well as ambient air remains above 15° C during application and curing of the materials while relative humidity does not exceed 75%.
- The A component should be thoroughly stirred to incorporate any slight separation, while continuing stirring, the hardener (B component) should be added. Continue stirring until a homogeneous mix is obtained.
- The application is done by airless sprayer or short-haired mohair roller in 2 crossing layers.

CONSUMPTION

200-250 gr/m² on polyurethane floorings

400-500 gr/m² on running tracks or EPDM surfaces.

Apply two layers at least.

APPLICATION TOOLS

Short-haired mohair roller or airless sprayer. Tools should be cleaned with **PU SOLVENT** immediately after use.



PACKAGING

Supplied in set of 20 Kg (two drums).



STORAGE

12 months in unopened containers in dry places with minimum temperature 5°C and maximum temperature 30°C (avoid sunlight).

REMARKS

- In case the layer of PU top coat is applied after more than 24 hours of the application of the last layer of PU pore filler then the whole surface must be sanded by a special sanding machine. After that the PU top coat can be applied.
- The second layer of **POLYSPORT 1052-SEMIMAT** has to be applied strictly within 24 hours, depending on the temperature and humidity (European conditions) **or within 3-6 hours (GCC high-temperature conditions)** in order to cover the surface swiftly and protect it from unwanted weather or other adverse conditions (sand dust, accumulated dirt or foreign matter etc.). In case the 24-hour limit (Europe) or the 3-6-hour limit (GCC) is surpassed or weather or other adverse conditions interfere between layers at any time, the surface might need sanding again to restore smoothness and cleanliness before applying subsequent layers of the aliphatic top coat.
- Working time of **POLYSPORT 1052-SEMIMAT** decreases when ambient temperature rises.
- Prolonged storage of partially used containers, containing **POLYSPORT 1052-SEMIMAT** must be avoided, as contact with atmospheric moisture could possibly cause clouding of the product.
- After hardening **POLYSPORT 1052-SEMIMAT** is completely safe for health.

CAUTION

The application must take place in well-aired places using protective gloves. Skin or eye contact must be avoided, otherwise wash carefully with soap and water.

For more information consult the safety data sheet.

The information given here is true, represents our best knowledge and is based not only on laboratory work, but also on field experience. However, because of numerous factors affecting results we offer this information without any guarantee and no patent liability is assumed. For additional information or questions, contact the technical department of KDF LTD.

CLEANING AND MAINTENANCE MANUAL FOR :

-OUTDOOR SPORTS FLOORING -PLAYGROUND FLOORINGS

Introduction

Outdoor sports floorings and playground surfaces are made of extremely durable polymers, designed to withstand extreme climate conditions and intense use. However for the best maintenance of the sports surface a regular check (once in 6 months) is required and the maintenance of the surface is necessary to preserve the suitability and functionality of the flooring.

The installer's guarantee will usually be conditional on the recommended maintenance requirements being carried out with due diligence.

Maintenance

Maintenance procedures are necessary to preserve the lifetime of the surface and to ensure that:

- The Surface is kept clean.
- The Surface is safe for intense and diverse use.

These objectives are achieved by :

- Sweeping/removing leaves and other debris from the surface.
- Regularly washing the surface with a soft brush to remove contaminants such as grime, grease, algae, moss, sand etc.
- Applying suitable treatments of moss-killer and/or algaecide
- Periodically removing weed growth from the perimeter kerb lines.

Maintenance Equipment

- Leaves, pine needles and other detritus should be removed from the surface immediately as rot quickly helping the growth of mold and moss.
- A mechanical leaf-sweeper or vacuum cleaner is ideal for removing vegetable matter and dirt. Restricted areas may have to be cleaned by hand.
- The maintenance equipment should be well maintained and carefully operated to avoid any physical damage to the surface.
- Pressure loads on the surface as well as friction and shearing loads have to be avoided to prevent damage to the surface.
- At least once a year it is advisable to wash the surface with **low-pressure** jetting apparatus.

- Polymeric surfaces can withstand low pressures without suffering damage.
- Note that no aggressive chemical cleaning agents (chlorine or acid-based) should be used.

Prevention of damages

To ensure the excellent condition of the surface:

- It is forbidden to drive vehicles, bicycles or motorcycles on the surface.
- Chemicals, oils, fuels or solvents on the surface are prohibited.
- Fireworks or cigarettes or unsuitable shoes on the surface are prohibited.

Damages and renovation

The lifetime of an outdoor sports/playground surface depends on its quality, usage and level of maintenance. In general a normal outdoor sports/playground surface used intensively will last 7 to 12 years (depending on the system) before renovation is required. Renovation should be carried out periodically to prevent the total damage of the surface, which would necessitate complete renewal.

Renovation must be carried out by professional and skilled contractors with thorough knowledge of this type of work.

There are different procedures for the renovation of a surface:

- Complete renewal by replacing the worn-out surface with a new sports flooring system.
- Re-topping or sealing with adequate polyurethane or acrylic materials.
- Partial re-topping in particular worn-out areas.

Information contained in this document is of general nature and is given in good faith. As the state of the surface and the use and application of the various cleaning products, is out of our control, our advice for individual cases, verbal, written or based on tests, does not exempt the applicator from the testing the suitability of the cleaning products and their applications.

The above maintenance guide refers to **the below KDF systems:**

-SYSTEM SPORTFLOOR FAST

-SYSTEM SPORTFLOOR-EX

-SYSTEM SPORTFLOOR-EX-R

-SYSTEM FLEXFLOOR-EX

-SYSTEM FLEXFLOOR-EX-R

-SYSTEM POLYFLEX AEL -EX

-SYSTEM POLYFLEX AEL -EX-R
-SYSTEM POLYFLEX WET -POUR EX
-SYSTEM POLYFLEX WET -POUR EX-R
-SYSTEM POLYFLEX PU -EX
-SYSTEM POLYFLEX WET -POUR AEL-EX
-SYSTEM POLYFLEX WET -POUR AEL-EX-R
-SYSTEM SMARTFLOOR-EX
-SYSTEM SAFEPOL MULTICOLOR
-SYSTEM SAFEPOL COLORED
-SYSTEM SAFEPOL WITH TPV GRANULES
-SYSTEM SAFEPOL SBR COLOURANT
-SYSTEM SAFEPOL SANDPROOF
-SYSTEM QUICKLAWN PLAYGROUND SAFEPOL
-SYSTEM QUICKLAWN PLAYGROUND SAFEPOLSANDPROOF
-SYSTEM COLORFLEX
-SYSTEM SPORTGROUND-EX
-SYSTEM DECOQUARTZ
-SYSTEM POLTRACK SPRAYCOAT
-SYSTEM POLTRACK SPRAYCOAT SEALED
-SYSTEM POLTRACK SANDWICH
-SYSTEM POLTRACK ROLL-SANDWICH
-SYSTEM POLTRACK FULL PU
-SYSTEM POLTRACK ACRYLIC
-SYSTEM POLTRACK JOGGING TRACK
-SYSTEM POLTRACK PU JOGGING TRACK
-SYSTEM POLTRACK JOGGING TRACK SBR
-SYSTEM POLTRACK JOGGING TRACK SHOCK-PAD - EPDM
-SYSTEM POLTRACK JOGGING TRACK SHOCK-PAD - ISOPOL
-SYSTEM POLTRACK EQUINE

INDICATIVE REFERENCE LIST OF PROJECTS

- RIYADH CITY NORTH PHASE 7A - ABHU DHABI, U.A.E - 80000m² Bicycle track, Sportground-Ex system
- RIYADH CITY NORTH PHASE 7B - ABHU DHABI, U.A.E - 60000m² Bicycle track, Sportground-Ex system
- CONSTRUCTION OF HARD LANDSCAPING - U.A.E - 60000m² Bicycle track, Sportground-Ex system
- RIYADH CITY SOUTH PHASE 1 - ABHU DHABI, U.A.E - 42000m² Bicycle track, Sportground-Ex system
- 12 SCHOOLS IN U.A.E, MINISTRY OF EDUCATION(THROUGH VARIOUS CONTRACTORS) - 40000m² EPDM Rubber flooring
- MULTIPLE RUNNING TRACKS - ALGERIA - 40000 m² - Running track, POLTRACK SPRAYCOAT system
- AL ESKAN RUNNING TRACK - BURAIDAH, K.S.A -25000m² -Running track, POLTRACK SPRAYCOAT system
- UNIVERSITY OF DAMMAM - KSA - 13000m² - Acrylic cushion floorings
- KING ABDULLAH BASE AIR DEFENSE - TAIF, KSA - 12600 m² - Running track
- KING FAHD UNIVERSITY OF PETROLEUM AND MINERALS-DHARAN, KSA-12400m²-Rubber outdoor flooring
- ”KOSTAS KENTERIS” STADIUM & NATIONAL STADIUM OF MITILINI - MITILINI ISLA, GREECE - 12000m² - Running track, POLTRACK SANDWICH system
- RUNNING TRACK - K.S.A- 11000 m² - Running track, POLTRACK SANDWICH system
- GEMS SCHOOL - DUBAI, U.A.E - 10000 m² - Running track
- PASARGRAD WHOLESALE MARKET-IRAN - 10000 m² - Decorative flooring
- YAS ISLAND, ABU DHABI, U.A.E - 10000m² Bicycle track
- ANASTASIA KELESIDOU STADIUM/KONSTANTINOS KARAMANLIS - THESSALONIKI, GREECE - 10000m²
- Re-topping project, Running track, Sandwich system, Indoor & Outdoor running track
- KAFTANZOGLIO NATIONAL STADIUM OF THESSALONIKI - GREECE - 9000m², POLTRACK SANDWICH
- ABHA STADIUM - K.S.A - 9000m²- POLTRACK SANDWICH system
- ABU DHABI STADIUM - U.A.E - 9000m² - Artificial Grass, POLITURF LEADER 55140
- ALEXANDRIA STADIUM - ALEXANDRIA, EGYPT - 8500 m² - Running track
- SICHUAN INVESTMENT INTERNATIONAL TENNIS CENTER - CHENGDU CHINA - 8250 m² - SPORTFLOOR-EX HARD COURT
- MINISTRY OF EDUCATION IN KUWAIT - KUWAIT - 8000m² - Polyurethane flooring, Polyflex Pu-In system
- SALAM STREET & MINA ROAD, ABU DHABI, U.A.E - 8000m² Bicycle track, Sportground-Ex system
- KING FAHAD NAVAL BASE - JUBAIL, KSA - 8000m² - Running track
- MUNICIPALITY OF VELVENTO - KOZANI, GREECE - 8000m², Running track
- PRINCE FAISAL STADIUM IN RIYADH - K.S.A - 8000m², Running track, POLTRACK SANDWICH system
- ABBHA, KSA - 7600m² - Running track
- MUNICIPALITY OF ZENICA - ZENICA, BOSNIA & HERZEGOVINA - 7500m², Poltrack Spraycoat, Running track
- RUNNING TRACK - KAMIANETS, PODILSKYI, UKRAINE - 7400m², Poltrack Spraycoat
- NATIONAL STADIUM OF TRIKALA - TRIKALA, GREECE - 7000m² - Running track POLTRACK FULL PU
- TELUK BAYAR MINI OLYMPI STADIUM - INDONESIA - 7000m² - Running track, POLTRACK SANDWICH
- ADNOC SCHOOLS - U.A.E - 7000m² - Safepol system
- MAJLIS BANDARAYA PETALING JAYA STADIUM - MALAYSIA - 7000m² POLTRACK SANDWICH
- ATLAS CENTER-BAM, IRAN - 7000 m² - Decorative flooring
- RUNNING TRACK - SUDAN - 7000 m² - Running track, POLTRACK SPRAYCOAT system
- COLOMBIA RUNNING TRACK PROJECT - 6800 m² - POLTRACK SPRAYCOAT
- MUNICIPALITY STADIUM ANDROS ISLA, GREECE - 6700m²- POLTRACK SANDWICH RETTOPING SYSTEM
- RUNNING TRACK STADIUM - CRETE, GREECE - 6500 m² - Running track, POLTRACK SANDWICH system

-PLAYGROUND PROJECT - ABU DHABI, U.A.E - 6500 m², Safety flooring

-RUNNING TRACK STADIUM - DRAMA, GREECE - 6500 m² - Running track, POLTRACK SANDWICH system

-SAADIYAT ISLAND - ABHU DHABI, U.A.E - 6500m² Bicycle track, Sportground-Ex system

-RUNNING TRACK PROJECT IN MUSCAT, OMAN - 6400 m² - POLTRACK SANDWICH system

-KAVALA STADIUM - KAVALA, GREECE - 6300m²- 8-lane Running track, POLTRACK SANDWICH SYSTEM

-CHENGDU SPORT UNIVERSITY - CHENGU, CHINA - 6300 m² - Cushion system, FLEXFLOOR-EX

-CORNISH, JEDDAH, K.S.A - 6000m² Bicycle track Sportground-Ex system

-MUNICIPALITY STADIUM-MOLAOI, GREECE - 5800m²- POLTRACK SANDWICH SYSTEM

-MUNICIPALITY STADIUM SOFADES, GREECE - 5800m²- POLTRACK SANDWICH SYSTEM

-MUNICIPALITY STADIUM OF ALIARTOS - ALIARTOS, GREECE - 5700m²- POLTRACK SPRAYCOAT

-ARTIFICIAL GRASS PROJECT - ATHENS, GREECE - 5700m², Artificial grass

-PAPACHARALAMBIO STADIUM - NAFPAKTOS, GREECE - 5650m² - POLTRACK SANDWICH system

-AMITY INTERNATIONAL SCHOOL - ABHU DHABI, U.A.E - 5500m², Poltrack Spraycoat, Running Track

-MUNICIPALITY STADIUM LOUTRAKI, GREECE - 5500m²- POLTRACK SANDWICH SYSTEM

-SHUQAIQ WATER AND ELECTRICITY COMPANY - JIZAN, KSA - 5400 m² - acrylic courts

-TALEEM UPTOWN SCHOOLS - DUBAI, UAE - 5400m²-Acrylic sports courts systems

-ZAYED PORT - ABHU DHABI, U.A.E - 5400m² Bicycle track, Sportground-Ex system

-SAN FERNANDO DE HENARES - SPAIN - 5300m² - POLTRACK SANDWICH

-SAUDI AIR FORCE - KSA - 5250 m² - Acrylic coating elastoturf, running track

-OMAN WATERFRONT - OMAN - 5000 m² - COLORFLEX-EX

-SHIV NADER SCHOOL - FARIDABAD, INDIA - 5000 m² - Running track, POLTRACK SANDWICH system

-RUNNING TRACK - K.S.A - 5000 m² - Running track, POLTRACK SANDWICH system

-AL HAMRA, RAS AL KHAIMAH, U.A.E - 5000m² Bicycle track, Sportground-Ex system

-AIRBASE IN TAIF - KSA - 5000 m² - Running track

-AMERICAN SCHOOL AL BARSHA - DUBAI - 5000 m² - Running track, POLTRACK SPRAYCOAT system

-MUNICIPALITY STADIUM AMFISSA, GREECE - 5000m²- POLTRACK SANDWICH SYSTEM

-NATIONAL STADIUM OF KALAMPAKA -KALAMPAKA, GREECE-4900m²-POLTRACK SEALED SPRAYCOAT

-MONTORNES DE VALLES - BARCELONA, SPAIN - 4900m² - POLTRACK SPRAYCOAT

-THAILAND STADIUM - 4800 m² - Running track, POLTRACK SANDWICH system

-UMM GHAFAH CYCLE TRACK - AL AIN, U.A.E - 4700m² Bicycle track, Sportground-Ex system

-LYCEE FRANCAIS INTERNATIONAL THEODORE MONOD - SADIYAT, ABU DHABI, U.A.E - 4650 m² - Art. Grass POLITURF LEADER 55140

-BIG SQUARE & LRT STREET, MASDAR CITY - ABHU DHABI, U.A.E - 4600m² Bicycle track, Sportground-Ex

-DEPARTMENT OF EDUCATION ASIR REGION - KHAMIS, KSA - 4500 m² - Running track

-SERVIA STADIUM - KOZANI, GREECE - 4500m², Running track

-STADIUM OF ISLAMIC CITY OF BAWATH IN AL-AZHAR - EGYPT - 4500m²- POLTRACK SANDWICH

-MUNICIPALITY STADIUM OF SOFADES - GREECE - 4500m²- POLTRACK SANDWICH SYSTEM

-BURGUILLOS STADIUM IN SEVILLA - SPAIN - 4400 m² - Running track, POLTRACK SPRAYCOAT system

-”POSIDONIO” NATIONAL ATHLETIC CENTER - THESSALONIKI, GREECE - 4300m²- Acrylic certified flooring

-MUNICIPALITY STADIUM OF MESSINI - GREECE - 4300m²- Running track, POLTRACK SANDWICH SYSTEM

-MUNICIPAL SPORTS CENTER VELOU-VOHA - PELOPONNISOS, GREECE - 4300m²- POLTRACK SANDWICH

-COMMUNITY COLLEGE - KHAMIS, KSA - 4200 m² - Running track

-FAYOUM INIVERSITY - EGYPT - 4200m² - Polyurethane sports flooring, POLYFLEX PU System

-POLIDEPORTIVO UNIVERSIDAD ALCALA DE HENARES-MADRID,SPAIN-4000m²-POLTRACK SPRAYCOAT

-SPORTS CLUB CENTER GLIFADA - ATHENS, GREECE - 4000m²- Poltrack Spraycoat, Running Track
-EMIRATES INTERNATIONAL SCHOOL - DUBAI, U.A.E - 4000m² - Safepol System, Playground flooring
-YAS NORTH EMMARATHI COMMUNITY - ABHU DHABI, U.A.E - 4000m² Bicycle track, Sportground-Ex system
-RUNNING TRACK PROJECT IN QATAR - 4000m², Poltrack Spraycoat system
-RUNNING TRACK PROJECT IN SAMOS - GREECE - 4000m², Poltrack Spraycoat system
-RECONSTRUCTION OF MOROCOCHA STADIUM - PERU - 3850m² - Running track, POLTRACK SANDWICH
-HH KHALID BIN BANDAR - RIYADH, KSA - 3800 m² - Volleyball/basketball rubber courts
-SPORTS FLOORING COMPLEX - ISRAEL - 3700 m², Acrylic sports flooring, SPORTFLOOR-EX system
-MUNICIPALITY STADIUM OF AGIA PARASKEVI, GREECE - 3700m²- POLTRACK SANDWICH SYSTEM
-MUNICIPALITY STADIUM OF HALKIDA - EUBOEA, GREECE - 3700m²- POLTRACK SANDWICH SYSTEM
-RUNNING TRACK- UKRAINE - 3600m² - RunningTrack, Poltrack Spraycoat system
-ANATOLIA GOLLEGE - THESSALONIKI, GREECE - 3600m², Running track
-AIMARJAN ASLAND – PARTIAL - 3600m²- Poltrack Sandwich, Running Track
-RUNNING TRACK - ISRAEL - 3500m² - Running track, POLTRACK SANDWICH system
-KING ABDULLAH UNIVERSITY TECHNOLOGY - K.S.A - 3500m² - Running track, POLTRACK SANDWICH system
-RUNNING TRACK PROJECT - EGYPT - 3500m² - Running track, POLTRACK SPRAYCOAT system
-BICYCLE TRACK PROJECT - GREECE - 3500m²- Acrylic sports flooring, SPORTGROUND-EX system
-MUNICIPALITY OF ALIMOS - ATHENS, GREECE - 3500m²- Acrylic sports flooring, SPORTFLOOR FAST
-MUNICIPALITY STADIUM OF HOLARGOS, ATHENS- GREECE - 3500m²- POLTRACK SANDWICH SYSTEM
-MATRIX SPORTING CLUB - EGYPT - 3400m² - Polyurethane outdoor flooring, Polyflex PU-EX System
-RUNNING TRACK PROJECT - EGYPT - 3400m² - Running track, POLTRACK SPRAYCOAT system
-SPORTS CLUB CENTER KISSAMOS - CRETE, GREECE - 3200m²- Poltrack Sandwich, Running Track
-AL LUSAIL SPORTS CLUB - DOHA, QATAR - 3200m² - Jogging track
-SPORTS CLUB CENTER - SERVIA, GREECE - 3200m² - Poltrack Sandwich, Running Track
-STADIUM CENTER - UKRAINE - 3200m²- RunningTrack, Poltrack Spraycoat system
-KING KHALID UNIVERSITY - ABHA, KSA - 3100 m² - Running track
-MUNICIPALITY STADIUM KRESTENA - GREECE - 3100m²- Poltrack Sandwich, Running Track
-ISLAMIC WORLD GARDEN - SHARJA, U.A.E - 3000m²- Safety flooring, SAFEPOL MULTICOLOR system
-AL FAIOUM UNIVERSITY - FAIOUM, EGYPT - 3000m²- Polyurethane indoor flooring, Polyflex PU-IN system
-RUNNING TRACK PROJECT - VELVEDOS MUNICIPALITY, GREECE - 3000m²- POLTRACK SANDWICH
-WADY DEGLA OCTOBER CLUB - CAIRO, EGYPT - 3000m²- Acrylic sports courts
-SPORTS CLUB CENTER “PAPAGOU”- ATHENS, GREECE - 3000m²- Poltrack Sandwich, Running Track
-PANORAMA SPORTS COMPLEX - THESSALONIKI, GREECE - 3000m², Running track
-PLAYGROUND FLOORING PROJECT IN NORTHERN GREECE - KILKIS, GREECE - 3000m²- SAFEPOL
-TENNIS HALL OF THE DEYANG OLYNPIC SPORTA CENTER - DEYANG, CHINA - 3000 m2 - SPORTFLOOR-EX
-BENHA SPORTS CITY - EGYPT - 3000m²- Acrylic sports courts
-SPORTS COMPLEX IN UKRAINE - 3000m² - Safety flooring, SAFEPOL MULTICOLOR system
-CHENAO TENNIS HALL OF THE CHONGGING OLYMPIC SPORTS CENTER - CHONGGING, CHINA - 3000 m2 -
SPORTFLOOR-EX
-JOGGING TRACK AT WATERFONT - K.S.A - 3000m² - POLTRACK JOGGING TRACK
-PLAYGROUND FLOORING IN SHARJA - U.A.E - 3000m² - Playground flooring, SAFEPOL MULTICOLOR
-SPORTS FLOORING PROJECT IN YEMEN - 3000m²- Acrylic sports courts, SPORTFLOOR-EX
-SPORTS SCHOOL PROJECT - ARTA, GREECE - 3000m²- Acrylic sports courts, POLYFLEX AEL-EX
-ALIMOS STADIUM - ALIMOS, GREECE - 2850m²- Running track, POLTRACK SANDWICH

-**INDIAN ARMY - SAGAR, INDIA** - 2800m²- Acrylic sports courts

-**COLEGIO INTERNACIONAL DE LA SERENA - CHILE** - 2800 m² - Running track, POLTRACK SANDWICH system

-**ALL SAINTS SCHOOL - MUMBAI, INDIA** - 2700 m² - PU outdoor sports flooring and running track

-**INDIAN INSTITUTE OF SCIENCE EDUCATION AND RESEARCH-BHOPAL,INDIA**-2700m²-Acrylic sports courts

-**RESORT IN RED SEA - EGYPT** - 2700m²- Acrylic sports courts, FLEXFLOOR-EX system

-**OUR OWN GOLF SCHOOL** - 2700m²- Poltrack Spraycoat, RunningTrack

-**BAILE FIGA, BISTRITA NASAUD - ROMANIA** - 2700m² - Safety flooring, SAFEPOL MULTICOLOR system

-**STADIUM STUDENSKA, SPORTS COMPLEX - BARNNA, BOULGARIA** - 2700m² - SPORTFLOOR-EX system

-**OUTDOOR SPORTS VENUE - VARNA, BULGARIA** - 2700 m² - Acrylic, ITF classified, 8 layers system

-**RAKS PALLIKOODAM SCHOOL - INDIA** - 2600m²- Acrylic sports courts, FLEXFLOOR-EX system

-**DPS GUNTUR SITE, NEW DELHI INDIA** - 2600m²- Acrylic sports courts, SPORTFLOOR-EX system

-**MUNICIPAL STADIUM OF PREVEZA - GREECE** - 2600m²- Running track, POLTRACK SANDWICH

-**HIGH SCHOOL COMPLEX - ATTIKA DISTRICT** - 2500m²- Acrylic sports courts, SPORTFLOOR FAST system

-**KURNISH AL KHOBAR - K.S.A** - 2500m² - Rubber flooring, COLORFLEX system

-**AL RAYAN, QATAR** - 2500 m² - Running track, POLTRACK SANDWICH system

-**MUNICIPALITY PARK OF TRIKALA - GREECE** - 2500 m² - Running track, POLTRACK FULL-PU

-**ALHOSN SPORTS COMPLEX** - 2400 m² - Running track, POLTRACK SANDWICH system

-**PROJECT BELICA - CROATIA** - 2300 m² - Running track, POLTRACK SPRAYCOAT system

-**MUNICIPAL SPORTS CENTER PAVLOU MELA - THESSALONIKI, GREECE** - 2300 m² - SPORTFLOOR-EX

-**MUNICIPALITY STADIUM OF DOXATO - GREECE** - 2300m²- POLTRACK SANDWICH SYSTEM

-**TORRES DE COTILLAS - SPAIN** - 2300m²- POLTRACK SPRAYCOAT

-**WADY DEGLA EL NAKHIL CLUB - CAIRO, EGYPT** - 2260m² - Acrylic sports courts, POLYFLEX AEL-EX

-**OUTDOOR SPORTS FLOORING PROJECT - INDIA** - 2250 m²- Acrylic sports courts, SPORTFLOOR-EX

-**SPORTS FLOORING PROJECT IN BULGARIA** - 2200 m²- Acrylic sports courts, SPORTFLOOR-EX system

-**LULU SCHOOL - ABU DHABI, U.A.E** - 2200 m² - SAFEPOL MULTICOLOR

-**TEACHERS COLLEGE - ABHA, KSA** - 2050 m² - Running track

-**MUSAB BIN OMAIR BOYS SCHOOL - BIN OMRAN, QATAR** - 2050 m² - PU outdoor sport flooring

-**BURAIRAT SCHOOL - RAK, UAE** - 2000 m² - Running track

-**SPORTS CENTRE OF GERAKAS - ATHENS, GREECE** - 2000m² - Acrylic sports courts, SPORTFLOOR-EX

-**HADAYEK ALAHRAM CLUB - GIZA, EGYPT** - 2000m²-PU outdoor sports flooring, POLYFLEX PU-EX WET- POUR

-**JP, ADA CIGANLIJA - BELGRADE, SERBIA** - 2000m² - SPORTFLOOR-EX

-**YASMINA SCHOOL - ABUDHABI, U.A.E** - 2000m² - Playground flooring, SAFEPOL MULTICOLOR

-**SCHOOL COMPLEX IN NAXOS ISLAND - GREECE** - 2000m² - Acrylic sports courts, SPORTFLOOR-FAST

-**MUNICIPALITY STADIUM OF MALIA, CRETE - GREECE** - 2000m²- POLTRACK SPRAYCOAT SYSTEM

-**AL SAILIYA BOYS SCHOOL - AL SAILIYA, QATAR** - 2000 m² - Polyurethane, outdoor sport flooring

-**KING KHALID UNIVERSITY - ABHA, KSA** - 2000 m² - Volleyball/basketball rubber courts

-**HH KHALID BIN BANDAR - RIYADH, KSA** - 2000 m² - Volleyball/basketball rubber courts

-**MUNICIPALITY STADIUM OF DRAMA - GREECE** - 2000m²- POLTRACK SANDWICH SYSTEM

-**RAWDA RASHEED PRIMARY SCHOOL FOR BOYS** - 2000 m² - Outdoor sports flooring

-**DEIRA INTERNATIONAL SCHOOL - DUBAI, U.A.E** - 2000 m² - POLYFLEX PU-IN

-**DAMIETTA GOVERMENT - EGYPT** - 2000m² - Running track, Poltrack Spraycoat Sealed System

-**MUNICIPAL STADIUM OF GIANNITSA-GIANNITSA,GREECE**-2000m² -Running track POLTRACK SANDWICH

-**AL WAKAIR BOYS SCHOOL - AL WAKRAH, QATAR** - 1950 m² - Polyurethane, outdoor sport flooring

-**THE LAKE DISTRICT - PUNE, INDIA** - 1950m²- Acrylic sports courts

-**PRESIDENTIAL GUARD COMMANDM MAHAWI - ABU DHABI, UAE** - 1900m² - Football court

-GEMS CAMBRIDGE INTERNATIONAL SCHOOL - HOSHIYARPUR, INDIA - 1900m² - FLEXFLOOR-EX
-MUNICIPALITY STADIUM KARPENISI, GREECE - 1900m²- POLTRACK SANDWICH SYSTEM
-UNITED (SABIC) SPORTS CLUB - 1900 m² - Rubber flooring
-OUTDOOR SPORTS FLOORING PROJECT - PAKISTAN - 1900 m² - WET-POUR POLYFLEX AEL-EX
-SHOOLS MINISTRY OF EDUCATION - KHAMIS, KSA - 1800 m² - Rubber flooring
-AL MAJAD AMPHITHEATER - SHARJA, UAE - 1800m² - Certified Jogging track
-MULTIPURPOSE COURTS - KEFALONIA, GREECE - 1800m² - SPORTFLOOR-EX
-QASSIM UNIVERSITY - KSA - 1800m² - Polyurethane sports flooring
-MODERN ENGLISH SCHOOL - EGYPT - 1785m² - Running track, POLTRACK SPRAYCOAT
-AL QADSIYA MODEL INDEPENDENT SCHOOL - ALWAAB, QATAR - 1770 m² - PU outdoor sport flooring
-MUNICIPAL SPORTS CENTER IN KIATO - GREECE - 1750 m² - POLTRACK SPRAYCOAT, SPORTFLOOR-EX
-IKNS SCHOOL - BAHRAIN - 1700 m² - Playground flooring, SAFEPOL MULTICOLOR system
-AL WAHDA SPORT ACADEMY CLUB - ABU DHABI, UAE - 1700 m² - Acrylic sports system
-MUNICIPALITY STADIUM OF AGIA VARVARA - GREECE - 1700m²- POLTRACK SPRAYCOAT SYSTEM
-MULTIPURPOSE ACRYLIC COURTS - BAHRAIN - 1700 m² - SPORTFLOOR-EX system
-ALSARH SCOOLES OF CIVIL - RIYADH, KSA - 1650m² - PU glue/Socccer field
-PLAYGROUND FLOORING PROJECT IN QATAR - 1650m² - SAFEPOL MULTICOLOR system
-ESTADIO PROVINCIAL DE SANDIA - PUNO, PERU - 1650m² - POLTRACK SANDWICH
-GD GOENKA PUBLIC SCHOLL - PURNIA, INDIA - 1630m²- Acrylic sport1600 m²
-MUNICIPALITY STADIUM OF AGIA VARVARA - GREECE - 1700m²- POLTRACK SPRAYCOAT SYSTEM
-MULTIPURPOSE ACRYLIC COURTS - BAHRAIN - 1700 m² - SPORTFLOOR-EX system
-ALSARH SCOOLES OF CIVIL - RIYADH, KSA - 1650m² - PU glue/Socccer field
-PLAYGROUND FLOORING PROJECT IN QATAR - 1650m² - SAFEPOL MULTICOLOR system
-ESTADIO PROVINCIAL DE SANDIA - PUNO, PERU - 1650m² - POLTRACK SANDWICH
-GD GOENKA PUBLIC SCHOLL - PURNIA, INDIA - 1630m²- Acrylic sport1600 m² - s courts
-CIVIL DEFENCE TRAINING CENTER, EASTERN PROVINCE - K.S.A - 1600 m² - POLTRACK SPRAYCOAT
-SPA RESORT DERENIVSKUPIA KI - UZHGOROD, UKRAINE - 1600 m² - Flexfloor-ex system, volleyball court
-CIVIL DEFENCE TRAINING CENTER, EASTERN PROVINCE - K.S.A - 1600 m² - POLYFLEX PU-IN
-IISER, INDIAN INSTITUTE OF SCIENCE EDUCATION AND RESEARCH - BHOPAL, INDIA - 1600m² - Acrylic sports courts, FLEXFLOOR-EX system
-EFKARPIA MUNICIPALITY - THESSALONIKI, GREECE - 1600m²- Acrylic sports courts,SPORTFLOOR-EX
-GRACANICA SPORTS CENTRE - KOSOVO - 1600m² - Running Track, POLTRACK PRAYCOAT system
-3 OUTDOOR BASKETBALL COURTS - RHODES ISL GREECE - 1600 m² - FLEXFLOOR-EX system
-RUNNING TRACK PROJECT IN BOSNIA & HERZEGOVINA - 1585² - POLTRACK PRAYCOAT
-THE MILITARY HOSPITAL - RIYADH, KSA - 1560 m² - Volleyball/basketball rubber courts-PU sports flooring
-STADIUM IN BAJRAM CURRI - TROPOJA, ALBANIA - 1550 m² - SPRAYCOAT system
-SCHOOL SPORTS COMPLEX IN POLIGIROS - GREECE - 1550m²- Acrylic flooring, SPORTFLOOR FAST
-AL FORSHAN SPORTS CENTRE - ABU DHABI, U.A.E - 1500m² - Smartfloor system, Acrylic flooring
-INDUSTRIAL FLOORING - BULGARIA - 1500m² - Epoxy flooring, Polepox Coat 814 system
-SCHOOL IN AL WAKRA CITY - DOHA, QATAR - 1500 m² - Playground flooring
-REAL SCHOOL SHAH ALAM - MALAYSIA - 1500 m² - POLTRACK SPRAYCOAT
-IRAQ ARMY CAMP - IRAQ - 1500m² - Acrylic flooring in 2,2mm
-BICYCLE TRACK PROJECT - LARISA-TRIKALA, GREECE - 1500 m² - SPORTGROUND-EX
-PROJECT GREEN LAND - DUBAI, UAE - 1500 m² - Jogging track
-UP TOWN SCHOOL - 1500m²- Poltrack Spraycoat, RunningTrack

-INDIAN AIR FORCE - ALLAHABAD, INDIA - 1450m² - Acrylic sports courts
-OUTDOOR SPORTS COURT COMPLEX - INDIA -1400m² - PU flooring, WET-POUR POLYFLEX PU-EX
-SPORTS FLOORING PROJECT IN KOSOVO - STREET BALL - 1400m²- SPORTFLOOR-EX
-DUBAI MODERN HIGH SCHOOL - DUBAI, UAE - 1375 m² - Acrylic sports courts
-PROJECT ECOGREEN - DUBAI, UAE - 1350 m² - Jogging track
-SAVA BASELINE ACADEMY - MALTA - 1350m² - SMARTFLOOR-EX
-TENNIS CLUB CENTER IN LJUBLJANA - SLOVENIA - 1350m²- SPORTFLOOR-EX
-SPORTS FLOORING PROJECT - BANSKO, BULGARIA - 1350 m² - Acrylic sports courts
-”10” NATIONAL TV STATION - KOSOVO - 1300 m² - Outdoor, acrylic flooring, WET POUR POYFLEX AEL-EX
-POLICE COMPLEX BARRACKS NIZWA - OMAN- 1300 m² - Colorflex, PU sport flooring
-POLICE COMPLEX BARRACKS AL AJAIZ - OMAN - 1300 m² - Colorflex, PU sport flooring
-POLICE COMPLEX BARRACKS KATMATMILAH SITE - OMAN- 1300 m² - Colorflex, PU sport flooring
-POLICE COMPLEX BARRACKS SUWAIQ - OMAN - 1300 m² - Colorflex, PU sport flooring
-POLICE COMPLEX BARRACKS AL KAMIL - OMAN - 1300 m² - Colorflex, PU sport flooring
-PLAYGROUND FLOORING - BAHRAIN - 1300m² - Safepol system
-POLICE COMPLEX BARRACKS SHINAS - OMAN - 1300 m² - Colorflex, PU sport flooring
-POLICE COMPLEX BARRACKS BHALA - OMAN - 1300 m² - Colorflex, PU sport flooring
-POLICE COMPLEX BARRACKS MUDHAIBI - OMAN - 1300 m² - Colorflex, PU sport flooring
-POLICE COMPLEX BARRACKS THUMRAIT - OMAN - 1300 m² - Colorflex, PU sport flooring
-BASKETBALL COURTS PROJECT - NEAPOLI, THESSALONIKI, GREECE - 1300m² - SPORTFLOOR-EX
-POLICE COMPLEX BARRACKS AL KHOUDH - OMAN - 1300 m² - Colorflex, PU sport flooring
-POLICE COMPLEX BARRACKS MAHDAH - OMAN - 1300 m² - Colorflex, PU sport flooring
-POLICE COMPLEX BARRACKS BID BID - OMAN - 1300 m² - Colorflex, PU sport flooring
-POLICE COMPLEX BARRACKS AL KHABOORA - OMAN - 1300 m² - Colorflex, PU sport flooring
-POLICE COMPLEX BARRACKS DHANK - OMAN - 1300 m² - Colorflex, PU sport flooring
-POLICE COMPLEX BARRACKS HAFEET - OMAN - 1300 m² - Colorflex, PU sport flooring
-POLICE COMPLEX BARRACKS AUQAD - OMAN - 1300 m² - Colorflex, PU sport flooring
-POLICE COMPLEX BARRACKS SUMAIL - OMAN - 1300 m² - Colorflex, PU sport flooring
-MATRIX SPORTING CLUB - EGYPT - 1300 m² - Acrylic flooring, Flexfloor System
-OUTDOOR SPORTS VENUE - KOSOVO - 1300 m² - POLTRACK SPRAYCOAT System
-MUNICIPALITY SPORTS CENTRE SYKIES, THESSALONIKI - GREECE - 1300m²- POLTRACK SANDWICH
-SPORTS HALL IBRI - MUSCAT, OMAN - 1300 m² - Indoor sports flooring POLYFLEX PU-IN
-IK TENNIS ACADEMY - MALTA - 1300 m² - SPORTFLOOR-EX HARD COURT
-ALHALAFI BREAK - RIYADH, KSA - 1276 m² - Rubber flooring
-DELHI PUBLIC SCHOOL - ETAWAH, INDIA - 1250m²- Acrylic sports courts, FLEXFLOOR-EX system
-SCHOOL SPORTS PROJECT - ARTASHAT, ARMENIA - 1250m²- COLORLFEX-EX
-GI-DHOFAR BEACH RESORT & SPA - OMAN - 1225 m² - Colorflex, PU sport flooring
-RLS BASIC EDUCATION SCHOOL SOHAR - OMAN - 1225 m² - Colorflex, PU sport flooring
-MIXED BASIC EDUCATION SCHOOL AL QABIL - OMAN - 1225 m² - Colorflex, PU sport flooring
-BOYS BASIC EDUCATION SCHOOL BARKHA - OMAN - 1225 m² - Colorflex, PU sport flooring
-GIRLS BASIC EDUCATION SCHOOL MUDHAIBI - OMAN - 1225 m² - Colorflex, PU sport flooring
-MIXED BASIC EDUCATION SCHOOL AL AMERAT - OMAN - 1225 m² - Colorflex, PU sport flooring
-UMSALAMA GIRLS SCHOOL - AL RAYYAN, QATAR - 1200 m² - Polyurethane, outdoor sport flooring
-SHERATON PARK - DOHA, QATAR - 1200 m² - Playground flooring
-RAWDA BIN JASSIM SCHOOL - AL AZIZIYAH, QATAR - 1200 m² - Polyurethane, outdoor sport flooring

-GEMS WESTMINSTER SCHOOL - DUBAI, U.A.E - 1200 m² - Acrylic sports courts

-SILVER SPORTS CLUB - INDIA - 1200m²- Acrylic sports courts

-OUR OWN SCHOOL - SHARJA, U.A.E - 1200m² - Acrylic sports courts

-SHARJAH FOOTBALL CLUB - SHARJAH, UAE - 1200 m² - Polyurethane basketball courts

-SHERATON PARK - DOHA, QATAR - 1200 m² - Playground flooring

-CHILE RUNNING TRACK PROJECT - 1200 m² - Running track, POLTRACK SPRAYCOAT system

-EGYPT RUNING TRACK PROJECT - 1200m², Running Track, POLTRACK SPRAYCOAT system

-EGYPT RUNING TRACK PROJECT - 1200m², Running Track, POLTRACK SANDWICH system

-ALIGARH MUSLIM UNIVERSITY - ALIGARH, INDIA - 1200 m² - Acrylic sports courts, FLEXFLOOR-EX system

-SUMMER RESORT, KIDS PALLY AREA - CHALKIDIKI, GREECE - 1200 m² - Playground flooring, SAFEPOL

-SPORTS FLOOR PROJECT IN PAKISTAN - 1200 m² - Acrylic sports courts, POLYFLEX AEL-EX

-SCHOOL COMPLEX - ZAKINTHOS, GREECE - 1200 m² - Acrylic sports courts, SPORTFLOOR FAST

-SYMBIOSIS COLLEGE - INDIA - 1180m²- Acrylic sports courts

-SPORTS PROJECT IN EGYPT - 1170m²- Acrylic sports courts, POLYFLEX AEL-EX

-PROFESSOR ABDULAZIZ ANQARI - RIYADH, KSA -1150m² - PU glue/Socccer field

-ACRYLIC, OUTDOOR SPORTS FLOORING PROJECT - KARACHI, PAKISTAN -1150m² - FLEXFLOOR-EX

-AL SAQID ISLAMIC ENGLISH SHCOLL-DUBAI,UAE-1100m²- Acrylic flooring, WET-POUR POLYFLEX AEL-EX

-REAL SCHOOL HULU LANGAT - MALAYSIA - 1100m² - POLTRACK SPRAYCOAT

-MAADI BRITISH SCHOOL- EGYPT - 1100m², Multipurpose court, COLORFLEX system

-OUTDOOR SPORTS PROJECT IN FOCSANI REGION - ROMANIA - 1100m² - POLTRACK SPRAYCOAT

-CENTRAL SQUARE OF MUNICIPALITY OF THERMI - THESSALONIKI, GREECE - 1100m², Decorative flooring MARMOR FLOOR system

-GREEK TECHNOLOGICAL EDUCATIONAL INSTITUTE OF THESSALIA - GREECE - 1100m², Running Track, POLTRACK SANDWICH system

-NANSHA INTERNATIONAL TENNIS CENTER - GUANGZHOU, CHINA - 1000 m² - SPORTFLOOR-EX

-KORYDALLOS DISTRICT - ATHENS, GREECE - 1100m² - FLEXFLOOR-EX

-CINEGUILLA - PERU - 1100m² - POLYFLEX PU-EX

-FIRST POINT SCHOOLS - DUBAI, UAE1100m² - Acrylic sports courts

-OUTDDOR SPORTS FLOORING PROJECT-ARTA, GREECE-1100m²-POLYFLEX AEL-EX & SPORTFLOOR

-TUMBES - PERU - 1100m² - POLYFLEX PU-IN

-DUBAI AMERICAN ACADEMY - DUBAI, UAE - 1080 m² - Acrylic sports court

-PRELUDE PUBLIC SCHOOL - AGRA, INDIA - 1070m²- Acrylic sports courts

-INDOOR SPORTS FLOORING PROJECT - JORDAN - 1055m² - Polyurethane POLYFLEX PU-IN

-ALMGBAL BREAK - RIYADH, KSA - 1050 m² - Rubber playground

-PLAYGROUND MULTI-PROJECT IN HUANCVELICA - PERU - 1050 m² - SAFEPOL MULTICOLOR

-BANIYAS CLUB AND AL AIN ENGLISH SPEAKING SCHOOL - ABU DHABI, UAE - 1000m² - Acrylic flooring

-WADY DEGLA LOTUS PROJECT - CAIRO, EGYPT - 1000 m² - Acrylic flooring, Wet-Pour Polyflex AEL-EX

-GRAVA SCHOOL COMPLEX - ATHENS, GREECE - 1000 m² - POLTRACK SANDWICH RETTOPING

-INDIAN AIR FORCE - VARANASI, INDIA - 1000m² - Acrylic sports courts

-MULTIPURPOSE COURT - K.S.A - 1000m²- WET-POUR POLEFLEX AEL-EX

-GARDENIA RESIDENTS - DUBAI, U.A.E - 1000 m² - SAFEPOL MULTICOLOR system

-JINDAL UNIVERSITY - SONIPAT, HARYANA, INDIA - 1000m² - PU flooring WET-POUR POLYFLEX PU-EX

-MINISTRY OF EDUCATION - DAMMAM, KSA - 1000 m² - PU indoor multipurpose sports flooring

-SHEIKH OBEID MAKTHOUM PALACE - 1000m² - Outdoor polyurethane flooring

-PAVILHAO POLIDESPORTIVO - SAO JOAO DA PESQUEIRA - PORTUGAL - 1000 m² - POLYFLEX PU-IN

-INDIAN AIR FORCE - AGRA, INDIA - 1000m² - Acrylic sports courts
-INDONESIA - 1000 m² - PU indoor multipurpose sports flooring
-FOOTBALL PITCH PROJECT IN CHALKIDIKI - GREECE-1000 m² Artificial Grass POLITURF TRIUMPH 60100
-INDIAN AIR FORCE - LUCKNOW, INDIA - 1000m² - Acrylic sports courts
-MULTIPURPOSE POLYURTEHANE INDOOR COURTS - F.Y.R.O.M - 1000m² - Polyflex PU-In system
-SODIC PROJECT - EGYPT - 1000m², Multipurpose court, COLORFLEX system
-MUNICIPALITY STADIUM OF LARISA "ALKAZAR"- GREECE -1000m²-POLTRACK SANDWICH RETTOPING
-INDIAN AIR FORCE - VARANASI, INDIA - 1000m² - Acrylic sports courts
-INTERNATIONAL SCHOOL OF CREATIVE SCHIENCE - SHARJAH, U.A.E - 1000m² - Safepol System
-INDIAN AIR FORCE - BIHTA, INDIA - 1000m² - Acrylic sports courts
-INDIAN AIR FORCE - DARBHANGA, INDIA - 1000m² - Acrylic sports courts
-AL AIN INDIAN SCHOOL - AL AIN, UAE - 1000m² - Football court
-GREEK AIR FORCE ACADEMY - TATOI, ATHENS, GREECE - 1000m² - PU flooring, POLYFLEX PU-IN
-DUBAI SCHOLRAS PRIVATE SCHOOL - DUBAI, U.A.E - 1000m² - Acrylic flooring in 2,2mm
-OBOOR SPORTS CLUB - EGYPT - 1000m² - Acrylic flooring
-CAMANA - PERU - 1000m² - POLYFLEX PU-IN
-INDOOR SPORTS PROJECT IN OMAN - MINISTRY OF EDUCATION - 1000m² - PU sports flooring
-VIT AP CAMPUS, AMARAVANTHI, VIJAYAWADA, ANDHRA PRADESH - INDIA - 985m² POLYFLEX PU-IN
-MONARCH INTERNATIONAL SCHOOL - 950m²- Acrylic sports courts, FLEXFLOOR-EX system
-FOOTBALL COURT - LIMASSOL, CYPRUS - 950m² - Artificial grass, POLITURF IMPERIAL 50140
-MULTISPORT FIELD GADIME - KOSOVO - 950m² - POLTRACK SPRAYCOAT
-COMMUNITY COLLEGE - KHAMIS, KSA - 940 m² - Polyurethane indoor multipurpose sports flooring
-GEMS METROPOLE SCHOOL - DUBAI, U.A.E - 900 m² - Playground flooring
-PLAYGROUND FLOORING IN KHARKIV-2 - UKRAINE - 900m² - SAFEPOL MULTICOLOR system
-MINISTRY OF EDUCATION - ABHA, KSA - 900 m² - Polyurethane indoor multipurpose sports flooring
-BAB AL SHAMS SPA HOTEL - DUBAI, UAE - 900m² - Football court
-STREET BALL COURTS - BOSNIA 7 HERZEGOVINA - 880m² - POLTRACK SPRAYCOAT system
-CAIRO FESTIVAL CITY ORIANA PROJECT - EGYPT - 855m² - Playground flooring, SAFEPOL MULTICOLOR
-INDIAN NAVY - KOCHI, INDIA - 850m² - Acrylic sports courts, FLEXFLOOR-EX system
-PARCONA - PERU - 850m² - POLYFLEX PU-EX
-SCHOOL SPORTS COMPLEX - K.S.A - 850m² - POLYFLEX AEL-EX
-CHICAUMA PROJECT - CHILE - 850m² - SAFEPOL MULTICOLOR
-JUBAIL - K.S.A - 850m² - WETPOUR POLYFLEX AEL-EX
-PLAYGROUND PROJECT IN KILKIS - GREECE - 850m² - Playground flooring, SAFEPOL MULTICOLOR
-GALGOTIAS UNIVERSITY - NOIDA, INDIA - 830m²- Acrylic sports courts, FLEXFLOOR-EX system
-KING KHALID UNIVERSITY - ABHA, KSA - 820 m² - Polyurethane indoor multipurpose sports flooring
-SCHOOL COMPLEX - KOSOVO - 820 m² - SPORTFLOOR-EX, ITF classified – class 4
-YLL MORINA SCHOOL - GJAKOVA, KOSOVO - 810m²- Outdoor sports project, POLTRACK SPRAYCOAT
-GYMNASIUM IN OBERHOFFEN - ALSACE, FRANCE - 800m²- POLYFLEX PU-IN
-SPORTS CENTER ANTIRIO - GREECE - 800m² - Running track POLTRACK SPRAYCOAT
-JINDAL UNIVERSITY - SONIPAT, HARYANA, INDIA - 800m² - POLTRACK JOGGING TRACK
-ARTIFICIAL GRASS - STATOVCHA, BULGARIA - 800m² - Artificial grass, POLITURF ROYAL 5588
-SCHOOL IN AL WAKRA CITY - DOHA, QATAR - 800m² - Polyurethane sports flooring
-LYCEE FRANCAISE PROJECT - BEIRUT, LEBANON - 800m² - Acrylic sports flooring

-SULTAN MANOR - RIYADH, KSA - 800m² - Polyurethane multipurpose sports flooring
-MINISTRY OF EDUCATION - AL KHARIZ, KSA - 800m² - PU indoor multipurpose sports flooring
-GEMS AMERICAN ACADEMY - ABU DHABI - U.A.E - 800m² - Running track POLTRACK SANDWICH
-INDOOR SPORTS COURT - MALAYSIA - 800m² - PU indoor sports flooring
-KID'S PLAY AREA IN MALL - MOROCCO - 800m² - PU indoor sports flooring, POLYFLEX PU-IN system
-MARASSI R1 PROJECT - EGYPT - 800m² - Playground flooring, SAFEPOL MULTICOLOR system
-SPORTS CENTER GLIFADA, ATHENS - GREECE - 800m² - Running track POLTRACK SANDWICH
-SPORTS CENTER VRILISIA, ATHENS - GREECE - 800m² - Running track POLTRACK SANDWICH
-DUBAI ENGLISH SPEAKING COLLEGE - DUBAI, UAE - 783m² - Acrylic flooring, SPORTFLOOR-EX
-MULTIPURPOSE COURT - YEREVAN - ARMENIA - 765m² - COLORFLEX-EX
-HAYATABAD PESHAWAR - INDIA - 750m² - Polyurethane sports flooring, POLYFLEX PU-IN
-SINGAPORE AIRLINES - SINGAPORE - 735m² - PU indoor sports flooring
-CJM MIZIARA SCHOOL - LEBANON - 730m² - WET-POUR POLYFLEX AEL-EX
-AL DAJAN COMPANY - GASIM, KSA - 722m² - Polyurethane sports flooring/Tennis court
-SELECTIVE GOVERNMENT HIGH SCHOOL - EGYPT - 720m², Outdoor sports flooring
-INDIAN AIR FORCE - AHMEDABAD, INDIA - 720m²- Acrylic sports courts
-FITNESS TIME - FAYSALIA, DAMMAM, KSA - 700 m²-PU indoor multipurpose sports flooring/running track
-FITNESS TIME YASMEEN - RIYADH, KSA - 700 m² - PU indoor multipurpose sports flooring/running track
-FERRARI WORLD - ABU DHABI, UAE - 700m² - Playground flooring
-KOHAT SPORTS COMPLEX - PAKISTAN - 700m² - PU flooring, POLYFLEX PU-IN
-FITNESS TIME JUNIOR - RIYADH, KSA - 700 m² - PU indoor multipurpose sports flooring/running track
-FITNESS TIME - OLAYA RIYADH, KSA - 700 m² - PU indoor multipurpose sports flooring/ running track
-FITNESS TIME WAHA - RIYADH, KSA - 700 m² - PU indoor multipurpose sports flooring/running track
-FITNESS TIME, NOOR BRANCH - DAMMAM, KSA -700 m² - PU indoor sports flooring and running track
-FITNESS TIME, ALAMEEN BRANCH - DAMMAM, KSA - 700 m² - PU indoor sports flooring and running track
-FITNESS TIME, PLUS RIYADH - RIYADH, KSA - 700 m² - PU indoor sports flooring and running track
-FITNESS TIME, SALAMA BRANCH BRO & FITNESS - JEDDAH, KSA - 700 m² - PU indoor sports flooring
-FITNESS TIME, 40th BRANCH - JEDDAH, KSA - 700 m² - PU indoor sports flooring and running track
-NASR CLUB- EGYPT - 700m², Multipurpose court, POLYFLEX WET-POUR system
-HUREL DOUBLE 3 - RAS AL KHAIMH, KSA - 700 m² - Shockpad plus acrylic coatings
-THE SUSTAINABLE CITY - DUBAI, U.A.E - 700 m² - Acrylic flooring
-PROJECT IN MALTA - 700 m² - Acrylic flooring, SPORTFLOOR-EX system
-EMAAR - EMIRATES HILLS 2 - DUBAI, U.A.E - 700m² - Basketball court, Acrylic flooring
-AIRFORCE SURBOTO PARK - NEW DELHI, INDIA - 680 m² - Polyurethane outdoor sports flooring
-INDIAN ARMY - DHRANGDHARA, INDIA - 670m²- Acrylic sports courts
-MT.SAINT PATRICK ACADEMY - INDIA - 665m²- Acrylic sports courts
-RAJIV GANDHI THERMAL POWER PLANT - HISAR, INDIA - 650m² - Acrylic sports courts, FLEXFLOOR-EX
-JAWAHARLAL NEHRU TECHNOLOGICAL UNIVERSITY ANANTAPURAMU - ANANTAPUR, INDIA - 650m² - Acrylic sports courts, FLEXFLOOR-EX system
-TILAL HOTEL - DUBAI, U.A.E - 650 m² - SAFEPOL MULTICOLOR system
-REGIONAL HQ AT BURAIMI - OMAN - 650 m² - Colorflex, PU sport flooring
-PLAYGROUND FLOORING PROJECT IN LARNAKA, CYPRUS - 650 m² - SAFEPOL MULTICOLOR system
-ROYAL OMAN POLICE TASK FORCE RUSTAQ - OMAN - 650 m² - Colorflex, PU sport flooring
-ROYAL OMAN POLICE TASK FORCE LIWA - OMAN - 650 m² - Colorflex, PU sport flooring
-ROYAL OMAN POLICE TASK FORCE AL SALIL - OMAN - 650 m² - Colorflex, PU sport flooring

-OUTDOOR TENNIS COURTS - KOSOVO - 650m² - Acrylic sports courts, SPORTFLOOR-EX
-ROYAL OMAN POLICE TASK FORCE IBRI - OMAN - 650m² - Colorflex, PU sport flooring
-ROYAL OMAN POLICE TASK FORCE IBRA - OMAN - 650m² - Colorflex, PU sport flooring
-ROYAL OMAN POLICE TASK FORCE AL SUR - OMAN - 650m² - Colorflex, PU sport flooring
-3 PICKLEBALL COURTS IN CRAZ CITY - AUSTRIA - 650m² - Acrylic sports flooring, FLEXFLOOR-EX system
-ROYAL OMAN POLICE TASK FORCE AL DUKUM - OMAN - 650m² - Colorflex, PU sport flooring
-ROYAL OMAN POLICE TASK FORCE AL BURAIMI - OMAN - 650m² - Colorflex, PU sport flooring
-OASIS COMPLEX - K.S.A - 650m² - WET-POUR POLYFLEX PU-IN system
-ROYAL OMAN POLICE TASK FORCE AL NIZWA - OMAN - 650m² - Colorflex, PU sport flooring
-ROYAL OMAN POLICE TASK FORCE AL SUWAIQ - OMAN - 650m² - Colorflex, PU sport flooring
-ABU DHABI MUNICIPALITY - ABU DHABI , UAE - 650m² - Acrylic flooring
-INDOOR BASKETBALL COURT - JUBAIL - K.S.A - 650m² - WET-POUR POLYFLEX PU-IN system
-ST. MARY'S SCHOOL - LEMESOS, CYPRUS - 650m² - Playground flooring, SAFEPOL MULTICOLOR
-ROYAL OMAN POLICE TASK FORCE AL SALALAH - OMAN - 650m² - Colorflex, PU sport flooring
-ROYAL OMAN POLICE TASK FORCE AL BARKHA - OMAN - 650m² - Colorflex, PU sport flooring
-ROYAL OMAN POLICE TASK FORCE KHOUDH - OMAN - 650m² - Colorflex, PU sport flooring
-MULTIPURPOSE COURTS - TIRANA, ALBANIA - 650m² - Acrylic sports flooring, FLEXFLOOR system
-PLAYGROUND FLOORING IN KHARKIV-3 - UKRAINE - 650m² - SAFEPOL MULTICOLOR system
-MOHAMMED JASSIM M AL THANI SCHOOL - UMSALALALI, QATAR - 620m² - PU outdoor sport flooring
-QATAR GEMS SCHOOL - DOHA, QATAR - 615m² - Polyurethane sports flooring
-VELOOR THRISSUR DISTRICT - KERALA, INDIA - 610m² - Acrylic sports courts, FLEXFLOOR-EX system
-PUBLIC PARK - ABU DHABI, U.A.E - 610m² - Acrylic sports courts, SPORTFLOOE-EX FAST system
-VAISHNO DEVI - DELHI, INDIA - 610m² - Polyurethane outdoor sports flooring
-EQUINE FLOORING - BAHRAIN - 600m², POLTRACK EQUESTRIAN SYSTEM
-THAILAND - 600m² - Acrylic sports courts
-VILLA SINMAC PARK - SAN ANTONIO, PERU - 600m² - SAFEPOL MULTICOLOR system
-WATER'S EDGE RESIDENTIAL DEV'T - YAS ISLAND, ABHU DHABI, U.A.E - 600m² Sportground-Ex system
-PLAYGROUND FLOORING IN BAHRAIN - 600m² - SAFEPOL MULTICOLOR system
-PLAYGROUND FLOORING IN KHARKIV - UKRAINE - 600m² - SAFEPOL MULTICOLOR system
-INDIAN ARMY - AGRA, INDIA - 600m² - Acrylic sports courts
-THE INTERNATIONAL SCHOOL - AGRA, INDIA - 600m² - Acrylic sports courts
-INDIAN ARMY - JHANSI, INDIA - 600m² - Acrylic sports courts
-THE SUSTAINABLE CITY - DUBAI, U.A.E - 600m² - Safepol system
-AMITY SCHOOL, JUMEIRAH ISLAND - DUBAI, UAE - 600m² - Safepol system
-QUEEN ZAIN AL SHARAF HALL - JORDAN - 600m² - POLYFLEX PU-IN
-OUR OWN ENGLISH HIGH SCHOOL - SHARJAH, U.A.E - 600m² - Flexfloor system
-OUR OWN ENGLISH HIGH SCHOOL - SHARJAH, U.A.E - 600m² - Polyflex Ael-EX system
-ST. FRANCIS INTER COLLEGE - HATHRAS, INDIA - 600m² - Acrylic sports courts, FLEXFLOOR-EX system
-ST. ANTHONY'S SENIOR SECONDARY SCHOOL - FARRUKHABAD, INDIA - 600m² - FLEXFLOOR-EX
-SKATING FOR KIDS - GUJARAT, INDIA - 600m² - Sportfloor system
-IMS COLLEGE - GHAZIABAD, INDIA - 600m² - Acrylic sports courts, FLEXFLOOR-EX system
-GALGOTIAS COLLEGE OF ENGINEERING - GR. NOIDA, INDIA -600m²-Acrylic sports courts,FLEXFLOOR-EX
-HOTEL COMPLEX IN DHERMI, ALBANIA - 600m² - Acrylic sports courts, SPORTFLOOR-EX system
-DANIEL BECCERA OCAMPO EDUCATIONAL INSTITUTION-MONQUEGUA,PERU - 580m²POLYFLEX PU-EX
-TATLAY AALI SPORTS COMPLEX - PAKISTAN - 500m² - PU flooring,POLYFLEX PU-IN

-NEW DUBAI BRADENTON SCHOOL- DUBAI, UAE - 570m² - Acrylic sports courts

-«CRONWELL PLATAMON RESORT» HOTEL IN PLATAMONAS - GREECE - 560m² - SPLASH PARK FLOORING, AQUASOFT-EX system

-DUBAI SILICON OSIS-CENTRAL PARK, DSO - DUBAI, UAE - 560 m² - Jogging track

-MPS WORLD SCHOOL - AGRA, INDIA - 560m²- Acrylic sports courts

-LEADERS INTERNATIONAL SCHOOLS - EGYPT - 560m²- PU sports courts

-PLAYGROUND PROJECT IN AL KASIM - K.S.A - 560m²- SAFEPOL MULTICOLOR

-HARTLAND INTERNATIONAL SCHOOL - U.A.E - 550m²- SAFEPOL MULTICOLOR system

-PLAYGROUND FLOORING PROJECT IN SINGAPORE - 550m²- SAFEPOL MULTICOLOR system

-ARMY LAW COLLEGE PUNE- PUNE, INDIA - 550m²- Acrylic sports courts, FLEXFLOOR-EX system

-AL WUKAIR GIRLS SCHOOL - AL WAKRAH, QATAR - 550m² - Polyurethane, outdoor sport flooring

-AL BUROUJ PROJECT, SPORTS CLUB - EGYPT - 550m² - Running track, POLTRACK SPRAYCOAT

-PLAYGROUND PROJECT IN CYPRUS - 550m²- SAFEPOL MULTICOLOR system

-BBPS - DELHI, INDIA - 512m² - Polyurethane outdoor sports flooring

-IVY STATE - PUNE, INDIA - 511m²- Acrylic sports courts

-KUNAL ICONIA - INDIA - 510m²- Acrylic sports courts

-PORT CISNE - CHILE - 500m² - SAFEPOL MULTICOLOR

-AGRICULTURE UNIVERSITY PESHAWAR - INDIA - 500m² - Polyurethane sports flooring, POLYFLEX PU-IN

-LJUBUSKY PROJECT - BOSNIA & HERZEGOVINA - 500m² - Acrylic sports flooring FLEXFLOOR-EX

-MURIDKE SPORTS COMPLEX-SHEIKHUPURA, PUNJAB, PAKISTAN - 500m²-PU flooring,POLYFLEX PU-IN

-CRNA REKA PETROL - NORTH MACEDONIA - 500m² - Acrylic flooring, FLEXFLOOR-EX

-ONE PARK AVENUE, SOBHA HARTLAND - U.A.E - 500m² - SAFEPOL MULTICOLOR system

-VARIOUS PLAYGROUND PROJECTS IN ABU DHABI - U.A.E - SAFEPOL MULTICOLOR system

-AMERICAN SCHOOL OF DUBAI - DUBAI, UAE - Acrylic sports courts

-ETIHAD MUSEUM - JUMEIRAH, DUBAI, UAE - Rubber flooring

-SHENZHEN CITY VALLEY - CHINA - Acrylic sports flooring

-CARPARKING - ABU DHABI, UAE - Acrylic flooring

-DUBAI MILLENIUM SCHOOL - QUSAIS, UAE - Acrylic sports courts

-AMERICAN UNIVERSITY - DUBAI, UAE – Acrylic outdoor sports flooring

-RAK ACADEMY - RAK, UAE - Acrylic flooring

-ISCS - SHARJA, UAE - Acrylic flooring

-THE INTERNATIONAL SCHOOL OF CHOUEIFAT - AJMAN, U.A.E - Sportground-Ex system

-THE KINDER GARDEN STARTERS - DUBAI, U.A.E - Safepol system

-AL ZAHIA PROJECT - SHARJA, UAE - Safepol system

-WADY DEGLA SHERATON CLUB - CAIRO, EGYPT - Acrylic sports flooring

-NEW DUBAI BRADENTON SCHOOL- DUBAI, UAE - 570m² - Acrylic sports courts

-PLAYGROUND PROJECT IN QATAR - SAFEPOL MULTICOLOR

-GEMS WELLINGTON SCHOOL - DUBAI, U.A.E - Safepol system

-JUMEIRAH RETAIL DEVELOPMENT - JUMEIRAH, DUBAI, UAE - Safety rubber flooring

-MR.ABDULRHMIN - JUBAIL, KSA - Rubber playground

-GEMS WESTMINISTER SCHOOL - DUBAI, U.A.E - Safepol system

-POLYURETHANE INDOOR SPORTS COURT - TIRANA, ALBANIA - Polyflex PU-In system

-MULTIPURPOSE COURTS - ODESSA, UKRAINE - Rubber flooring

-MULTIPURPOSE COURTS - ZHOVKVA, UKRAINE - Rubber flooring

-MUNICIPAL TENNIS CLUB - PATRA, GREECE - Flexfloor-EX system, Acrylic sports courts

-INDIAN AIR FORCE - GORAKHPUR, INDIA - Acrylic sports courts

-INDIAN AIR FORCE - BAREILLY, INDIA - Acrylic sports courts

-INDIAN ARMY - BABINA, INDIA - Acrylic sports courts

-ADAM AIRBASE PACKAGE 8, OMAN - Colorflex, PU sport flooring

-GOLD GYM - KOLKATTA, INDIA - Polyurethane indoor sports flooring

-MINISTRY OF FOREIGN AFFAIRS - ABU DHABI, UAE - Polyurethane flooring

-SHRJAH SPORTS CLUB - SHARJAH, UAE - Polyurethane flooring

-GEMS WINCHESTER SCHOOL - AL BARSHA SOUTH, UAE - Acrylic sports system

-HOTEL DOUBLE 3 - RAS AL KHAIMAH, UAE - Prefabricated shock-pad 4mm plus acrylic coatings

-ALNABBAGH STABLE - AL AIN, U.A.E - Polyurethane flooring, POLTRACK EQUESTRIAN FLOORING

-AL WAHDA CLUB - ABU DHABI, UAE - Rubber flooring

-ADJD MAIN BUILDING LANDSCAPE PROJECT - ABU DHABI, UAE - Rubber flooring

-KADEEJ AL KURBA SCHOOL - ABU DHABI, UAE - Rubber flooring

-INTERNATIONAL SCHOOL OF CREATIVE SCIENCE-SHARJA, U.A.E-Flexfloor system/Outdoor Multipurpose court

-ENVIRO, VATIKA HOTELS PVT.LTD - GURGAON, INDIA - Acrylic sports flooring

-ASHIANA - BHUBANESHWAR, INDIA - Acrylic sports flooring

-TCS, ADIBATLA - HYDERABAD, INDIA - Acrylic sports flooring

-IPS, ERODE - CHENNAI, INDIA - Acrylic sports flooring

-LIONS GATE - MUMBAI, INDIA - Acrylic sports flooring

-MORNING GLORY INFRA LIMITED - KANPUR, INDIA - Acrylic sports flooring

-SPORTS HALL ZVORNIK - BOSNIA & HERZEGOVINA - PU flooring POLYFLEX PU-IN

-NAMBIAR - BANGALORE, INDIA - Acrylic sports flooring

-PATHWAYS - GURGAON, INDIA - Acrylic sports flooring

-WELHAMS GIRLS SCHOOL - DEHRADUN, INDIA - Acrylic sports flooring

-WOODDUCK COMMERCIAL CENTER- IRAN - Industrial flooring

-ARABIAN RANCHES by EMAR - DUBAI, U.A.E - Playground flooring

-OUR OWN ENGLISH HIGH SCHOOL - SHARJAH, U.A.E - Playground flooring

-POLO CLUB GHANTOOT - ABU DHABI, U.A.E - Polyurethane flooring, POLTRACK EQUESTRIAN FLOORING

-RAK MODERN SCHOOL - RAS AL KHAIMAH, U.A.E - Playground flooring

-GIIS/GLOBAL INDIAN INTERNATIONAL SCHOOL - RAS AL KHAIMAH, U.A.E - Playground flooring

-MINISTRY OF EDUCATION, NAD AL HAMAR BOYS SCHOOL - DUBAI, U.A.E - Playground flooring

-K.G. KIDS SCHOOL - AALI, BAHRAIN - Playground flooring

-SABIC BEACH CAMPS PROJECT - JUBAIL, K.S.A - Outdoor sports flooring, artificial grass.

-MINISTRY OF EDUCATION, MIZHER GIRLS SCHOOL - DUBAI, U.A.E - Playground flooring

-WARSAN STABLE - Polyurethane flooring, POLTRACK EQUESTRIAN FLOORING

-AL SHIMAL PARK - DOHA, QATAR - Playground flooring

-UM SELAL PARK - DOHA, QATAR - Playground flooring

-GEMS METROPOLE SCHOOL - DUBAI, U.A.E - Hard court system/Outdoor Multipurpose court

-ARABIAN RANCHES by EMAR - DUBAI, U.A.E - Acrylic Outdoor Tennis and Basketball courts

-RAK MODERN SCHOOL - RAS AL KHAIMAH, U.A.E - Flexfloor system

-GIIS/GLOBAL INDIAN INTERNATIONAL SCHOOL - RAS AL KHAIMAH, U.A.E - Acrylic system

-AVALON HEIGHTS - AJMAN, U.A.E - Acrylic floorings

-DELHI PRIVATE SCHOOL - DUBAI, U.A.E - Acrylic flooring

-ROYAL COMMISSION SCHOOL - JUBALI, KSA - Acrylic sports flooring

-FITNESS TIME PRO - AL AHSA BRANCH - KSA - Flexfloor, Basketball court
-FITNESS TIME PRO - MAKKAH SHARAIE - KSA - Flexfloor, Basketball court
-BIN HAM - AL AIN, UAE - Polyurethane flooring
-SHAMMA BINT MOHAMMED SHOOL - AL AIN, UAE - Polyurethane flooring
-ABDULLAH BIN OTAIBA - ABU DHABI, UAE - Polyurethane flooring
-LIWA INTERNATIONAL SCHOOL - AL AIN, U.A.E - Colorflex outdoor sport system
-ZOHOUR KG - MANAMA, BAHRAIN - Polyurethane sports flooring
-RAWDA RASHED - QATAR- Polyurethane, outdoor sport flooring
-SAAD BIN ABI WAQAS SCHOOL - AL RAYYAN, QATAR - Polyurethane, outdoor sport flooring
-FITNESS TIME PRO - MADINS RING ROAD BRANCH - KSA - Flexfloor, Basketball court
-AGRA CHAIN - AGRA, INDIA - Acrylic sports flooring
-SUNWORLD - NOIDA, INDIA - Acrylic sports flooring
-SSN INVESTMENTS PRIVATE LIMITED, FRIENDS COLONY - DELHI, INDIA - Acrylic sports flooring
-AJNARA - NOIDA, INDIA - Acrylic sports flooring
-BRIGHT RIDERS SCHOOL - ABU DHABI, UAE - Running track, Acrylic sports court
-OUR OWN ENGLISH HIGH SCHOOL - SHARJAH, U.A.E - Poltrack Spaycoat system
-NCC - JAIS, INDIA - Acrylic sports flooring
-ALPHA FOUNDATION FOR EDUCATION & RESEARCH - TRICHIRAPALLI, INDIA - Acrylic sports flooring
-PUSHPANJALI FARMS - NEW DELHI, INDIA - Acrylic sports flooring
-M3M - MERLIN GURGAON, INDIA - Acrylic sports flooring
-NORTH LONDON COLLEGIATE SCHOOL - DUBAI, U.A.E - Playground flooring
-FOOT COURT - EGYPT - Running track, POLTRACK SPRAYCOAT system
-FITNESS TIME ANDALUS BRANCH - JEDDAH, K.S.A - Acrylic sports flooring, FLEXFLOOR SYSTEM
-ST.JOSEPHS WOMENS COLLEGE - ALLEPPEY, KERALA, INDIA - Polyurethane outdoor sports flooring
-RAILWAY SPORTS GROUND - GUNTAKAL, ANDRA PRADESH, INDIA - Acrylic sports flooring
-TERVEL PROJECT - TERVEL, BULGARIA - Playground flooring, SAFEPOL system
-INDOOR COURT - UKRAINE - Polyflex PU-In system
-PRIVATE JOB - HYDERABAD, SOUTH INDIA - Acrylic outdoor sports flooring
-RAILWAY SPORTS GROUND -GUNTAKAL, ANDRA PRADESH, INDIA-Acrylic outdoor sports flooring, 5 layers
-VARIOUS PLAYGROUND PROJECTS IN ABU DHABI - U.A.E - SAFEPOL MULTICOLOR system
-POLYURETHANE OUTDOOR SPORTS COURT - QATAR - POLYFLEX PU-EX system
-QASR AL SARAB DESERT RESORT - ABU DHABI, U.A.E - SAFEPOL MULTICOLOR
-SPORTS CENTER IN HANOI - VIETNAM - POLYFLEX PU-IN
-NIELSON BUKA RESORT - KALAMATA, GREECE - FLEXFLOOR-EX
-PARALYMPICS FEDERATION SPORTS CENTER - CAMBODIA - POLYFLEX PU-IN system
-MINISTRY OF EDUCATION U.A.E - Playground flooring
-PLAYGROUND FLOORING - VARNA, BULGARIA - SAFEPOL System
-INDIAN ARMY - SHAHJAHANPUR, INDIA - Acrylic sports courts, FLEXFLOOR-EX system
-AIR FORCE SCHOOL - BENGALURU, INDIA - Acrylic sports courts, FLEXFLOOR-EX system
-ARMY PUBLIC SCHOOL - UDHAMPUR, INDIA - Acrylic sports courts, FLEXFLOOR-EX system
-BAHRAIN ROYAL EQUESTRIAN AND ENDURANCE FEDERATION - BAHRAIN - PU Equestrian system
-PLAYGROUND PROJECT - HONG KONG - SAFEPOL MULTICOLOR system
-PLAYGROUND PROJECT - KOSOVO - SAFEPOL MULTICOLOR system
-KIND SAUDI UNIVERSITY - RIYADAH, K.S.A - Running track, POLTRACK SPRAYCOAT ASYSTEM
-TENNIS COURT IN MYKONOS, GREECE - Acrylic sports courts, POLYFLEX AEL-EX system

- TENNIS COURT PROJECT - PAKISTAN** - Acrylic sports courts, SPORTFLOOR-EX-R system
- SHENZHEN CITY VALLEY - CHINA** - Acrylic sports courts
- QAYYUM STADIUM PESHAWAR - INDIA** - Polyurethane flooring POLYFLEX PU-IN
- PLAYGROUND FLOORING IN CYPRUS** - SAFEPOL MULTICOLOR system
- PLAYGROUND FLOORING - PRNJAVOR, BOSNIA & HERZEGOVINA** - SAFEPOL MULTICOLOR system
- BASKETBALL & BADMINTON COURTS-ASHIANA DAKSH-INDIA**-Polyurethane flooring POLYFLEX PU-EX
- BASKETBALL & BADMINTON COURTS-ASHIANA UMANG-INDIA**-Polyurethane flooring POLYFLEX PU-EX
- MULTIPURPOSE COURT - GUATEMALA** - POLYFLEX AEL-EX-R
- PLAYGROUND PROJECT - K.S.A** - SAFEPOL MULTICOLOR
- PLAYGROUND PROJECT IN JUBAIL - K.S.A** - SAFEPOL MULTICOLOR
- REPTON SCHOOL - DUBAI, U.A.E** - SAFEPOL MULTICOLOR
- PLAYGROUND PROJECT IN TEL AVIV - ISRAEL** - SAFEPOL MULTICOLOR
- PLAYGROUND PROJECT IN RISHON LEZION - ISRAEL** - SAFEPOL MULTICOLOR
- PLAYGROUND PROJECT IN ILION - ATHENS,ISRAEL** - SAFEPOL MULTICOLOR
- PLAYGROUND PROJECT WATERFORIN OF SAN ANTONIO - CHILE** - SAFEPOL MULTICOLOR